

20 Linear Wall Wash Semi-Recessed Bezel Trim

whitegoods

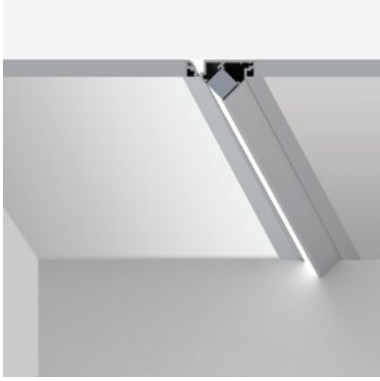

Ordering Information

Model	Fixation	Pattern	Length	Power ¹	CRI/CCT ²	Driver ³	Lens	Finish
WG-20LWW		S						
WG-20LWW	SRBT SRGT9 SRGT15	S	A	L M	927 930 935 940	X SW D010 DALI LE	OD (std) SD	W (std) B G F

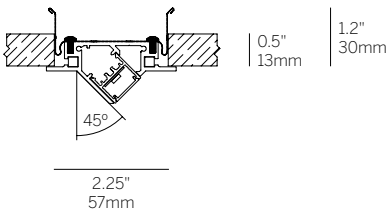
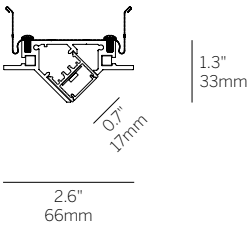

Solid Ceiling (SRBT)

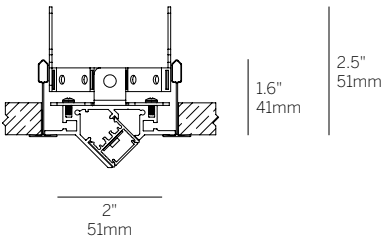

Grid Ceiling (SRGT9/SRGT15)

Luminaire

- Continuous, evenly illuminated snap-in lens without visible LED pattern.
- Standard Opal Diffuser for even illumination and no LED appearance. Satin Diffuser for high efficiency and minimal LED appearance.
- Field replaceable LED boards.
- 90+ CRI, 3 steps MacAdam.
- Lengths factory cut to exact field dimensions.
- Powder coat painted white - RAL 9010.
- Supplied with 4' (1220mm) class 2 plenum rated feed cable per fixture lengths.

Fixation

- SRBT = Semi Recessed Bezel Trim
- SRGT9 = Semi Recessed Grid Trim 9/16" (14mm)
- SRGT15 = Semi Recessed Grid Trim 15/16" (24mm)

Pattern

- S = Straight run

Length

- A = specify inches to the nearest 0.25" (6.35mm), i.e. 72.25" (1835mm)

Power¹

- L = 10.5W/m low power (24V)
- M = 21W/m mid power (24V)

CRI/CCT²

- 90+ CRI minimum (Low/Mid)
- 927 = 2700K (617/1141 lm/m)
- 930 = 3000K (636/1177 lm/m)
- 935 = 3500K (649/1200 lm/m)
- 940 = 4000K (656/1214 lm/m)

Driver (remote)³

- X = Driver ordered separately
- SW = Switched/NON DIM
- D010 = 0-10V/1-10V DIM
- DALI = DALI DIM
- LE = Leading-Edge DIM

Lens

- OD = Satin opal diffuser (standard)
- SD = Satin clear diffuser (high efficiency)

Finish

- W = White, 20% gloss, RAL9010 (standard)
- B = Black, 20% gloss
- G = Gray, 20% gloss
- F = Custom finished trim, specify RAL

Emergency

- Emergency LED driver available, order separately (remote)

1 Wattage shown does not include power supplies/drivers.

2 Delivered lumens with satin opal diffuser shown.

3 Remote power supply required. See power supply page for details.

