

150 Square Ceiling Wash LED

whitegoods

Project Title:

Luminaire Ref:



plaster-in

Ordering Information				
Code	Module	Dimming	Voltage	Emergency
P150SCFW* plaster-in B150SCFW* bezel	CL-830-1500* 80 CRI 12.9W 1500 lm	ND non-dim 0-10V 0-10 Volt dim 1-10V 1-10 Volt dim TR trailing edge dim DALI DALI protocol	220-240V standard 120 - 277V universal	EMND non-dim EMST self-test EMDA DALI

* Items available for Quickship

Product Description

A 150mm high level ceiling wash luminaire with bezel trim or trimless 'plaster-in' for absolute minimal visual impact.

Finish

Standard product finish is white powder coated RAL 9010 with 30% gloss.

Cut-out

170 x 170 mm

Fixture requires 130mm wall gap for installation.



Dimming

- ND: non-dimming
- 0-10V: 0-10 Volt dimming, min 0.1%
- 1-10V: 1-10 Volt dimming, min 0.1%
- TR: trailing edge dimming
- DALI: DALI protocol, min 0.1%

All drivers are suitable for remote mounting up to 10 meters from fixture. Longer distances are available on request.

Emergency

EMND: emergency non-dimmable

EMST: emergency self-test

EMDA: emergency DALI protocol

Note

- Manufacturing LED module detail shown. Refer to photometry data for typical results.
- All LED modules available in 2700, 3000, 3500 and 4000 Kelvin.
- Luminaires rated at 40°C maximum ambient temperature.

Minimum wall gap for emergency system is required, contact Whitegoods for further details.

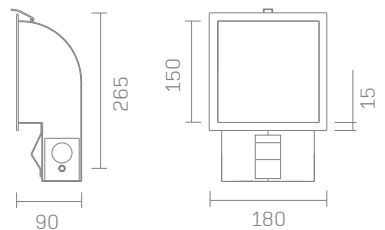
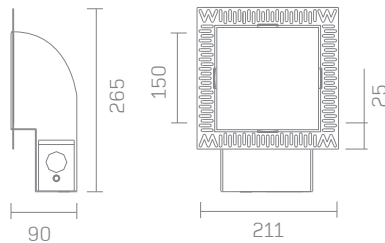

Example LED module codes

CL-830-1500

CL = Cited

830 = 80CRI, 3000K colour temperature

1500 = up to 1500 lumen package

Examples of typical output options

CL-827/830/840

Run @ 350mA = 1525lm, 12.9W

Specifier Details