



whitegoods

Our philosophy:

- Reduction of detail
- Seamless architectural integration
- Logical, modular systems and families of products
- Ease of specification, installation and maintenance

Recognising the needs of specifiers who want to create harmonious environments, we continue to develop our family of luminaires and other lighting tools that allow the specifier to treat a complete installation with one unified style. We classify our range in three categories:

Plaster-in: recessed and completely trimless, this is the most discreet range of luminaires you are ever likely to see. Total integration with architecture.

Bezel: recessed luminaires with a traditional bezel trim, but we have worked hard to ensure the minimum visual impact of these luminaires. You will not find a logo printed anywhere visible on our products.

Surface: dedicated for solid ceiling, wall or architectural surface with little or no recess depth.

Suspended: to compliment surface or recessed fitting where the ceiling height of a space changes but a continuous plane of light is required.

Tailored: fully integrated system solutions which can be tailored specifically to the architecture. These architectural lighting tools can be specified where otherwise laborious detailing would be required. Designed to meet the most demanding of projects, these systems are none the less very simple to specify.

If, like some of our clients, you have an application that is not met by our products (even with all of the options available within the standard and tailored product!) then we can provide totally custom solutions. Obviously any product which we produce will benefit from the same rigorous attention to detail and careful thought applied to the lit effect, the installation and the maintenance procedure.

family approach

Uniform dimensions are used across all whitegoods luminaires giving opportunities to use families of fittings to create whole integrated lighting solutions. These are just a few simple suggestions, please contact us with your ideas and we will help you to realise them.

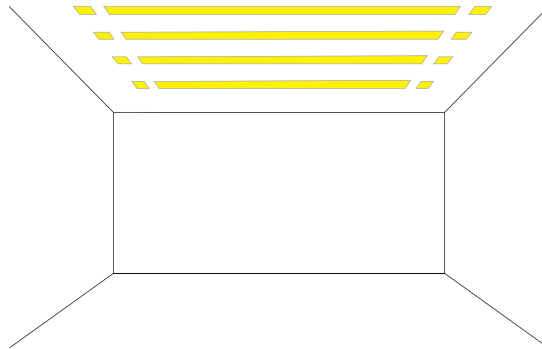

1. linear and downlights

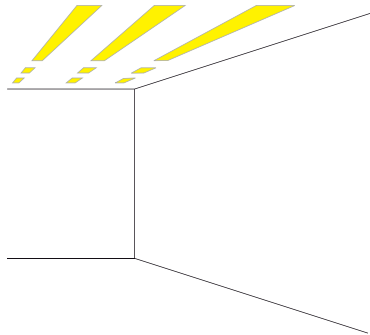

2. linear and downlights

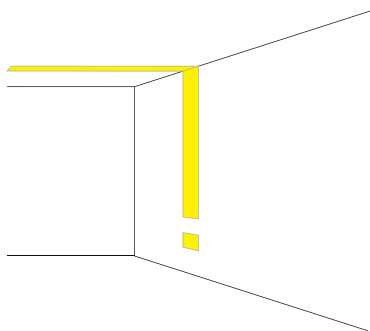

3. linear and floorwash

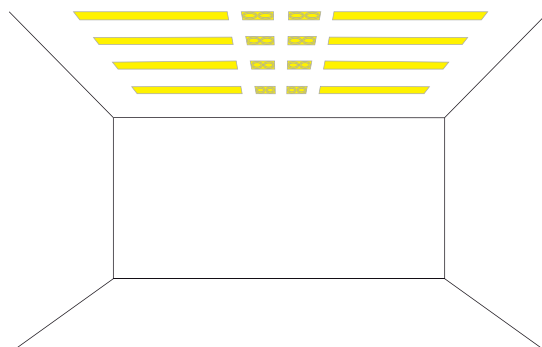

4. linear and gimbals

UGT fluorescent modular system

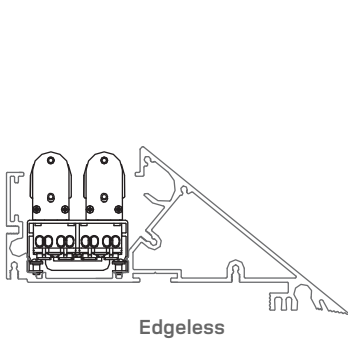
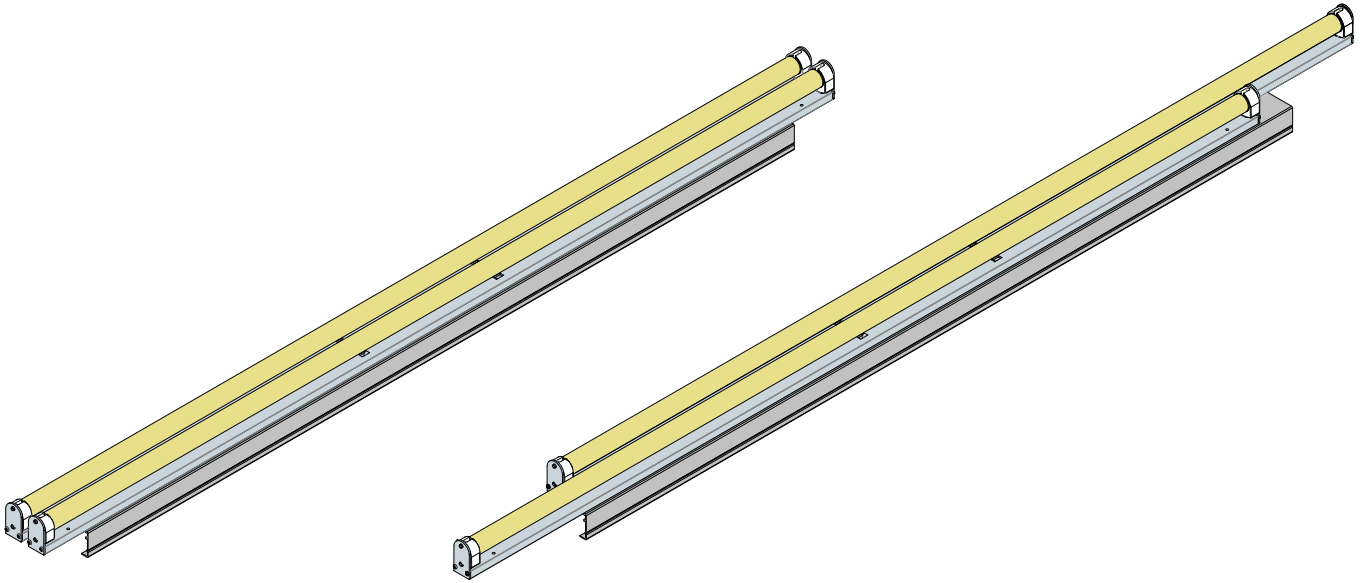

Edgeless

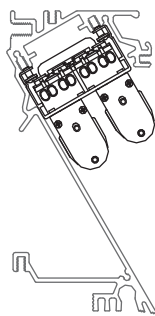

Z Cove

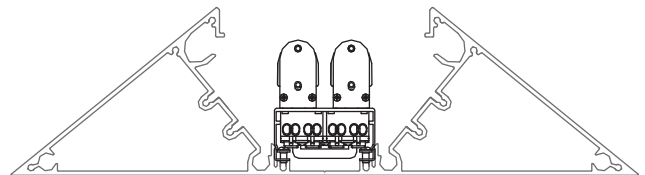

Line of Light

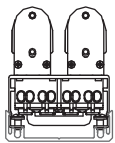

Light Strip

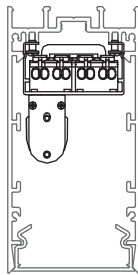

60 Linear

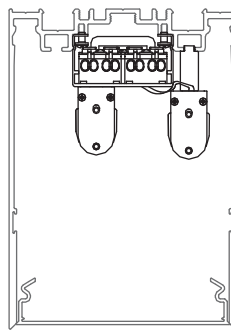

100 Linear

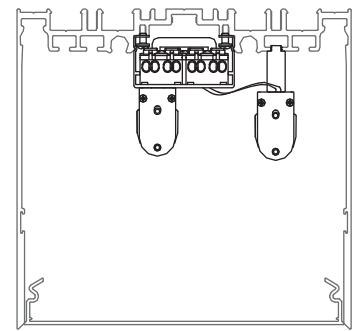

150 Linear

tool free elements

Wherever possible whitegoods products are designed to be installed and maintained as simply as possible. By reducing the need for tools, the second fix on site and future maintenance can be completed easily and quickly. From the in-line electrical connector to the simple fix gear tray and the friction fit diffuser, the whole system is designed with simplicity in mind. whitegoods: minimal, practical, functional.



1



2

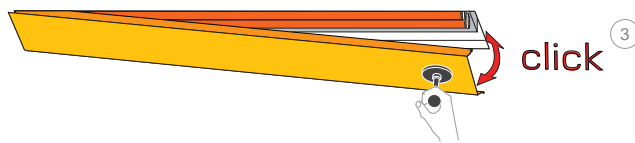

3

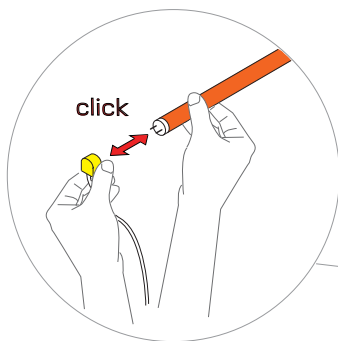

4



5

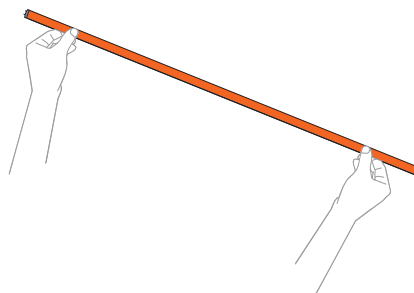

tool free elements

Wherever possible, whitegoods products are designed to be installed and maintained as simply as possible. By reducing the need for tools, the second fix on site and future maintenance can be completed easily and quickly. From the in-line electrical connector to the simple fix gear tray and the friction fit diffuser, the whole system is designed with simplicity in mind. whitegoods: minimal, practical, functional.

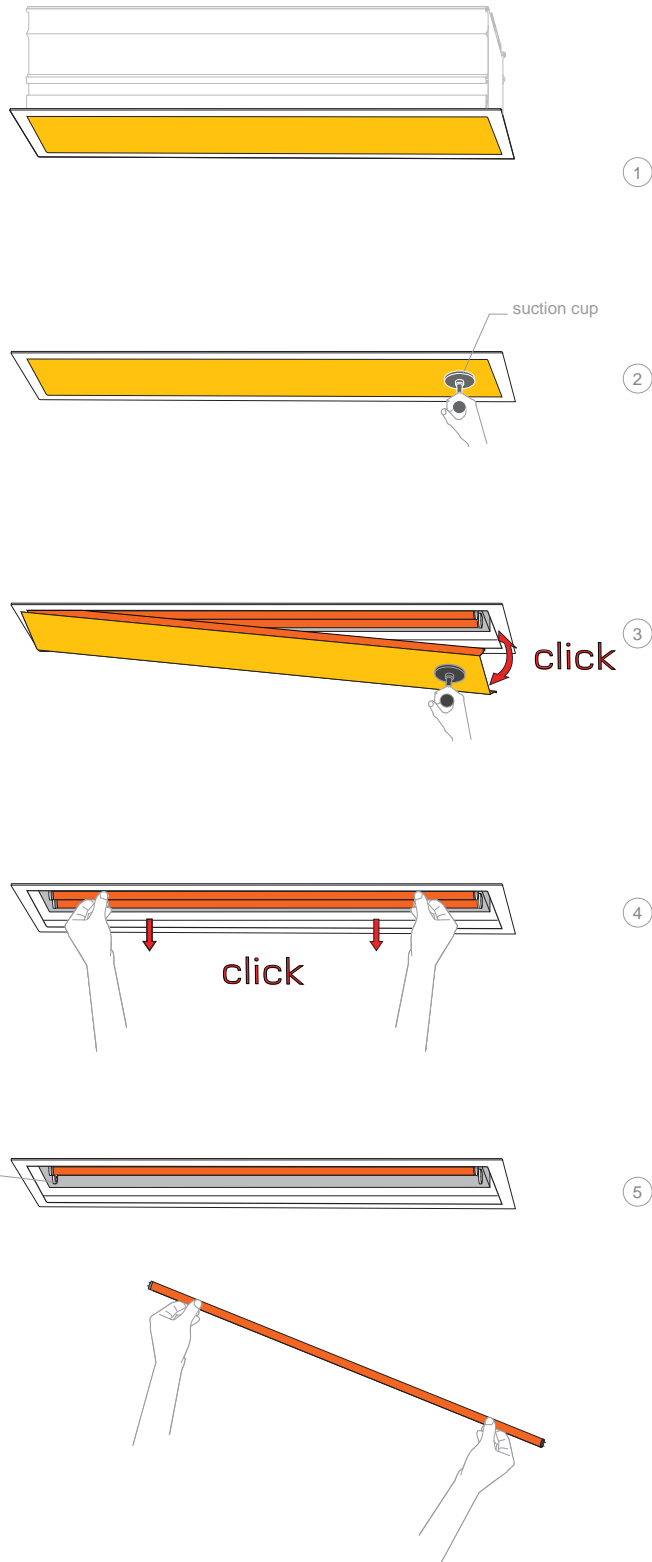

linear luminaire component maintenance

easy maintenance

Even the toughest maintenance jobs are completed in minutes with whitegoods practicality. In the unlikely event of a component failure, simply pop out the diffuser and remove the whole gear tray for the inspection. Simply replace in reverse. whitegoods: minimal, practical, functional.

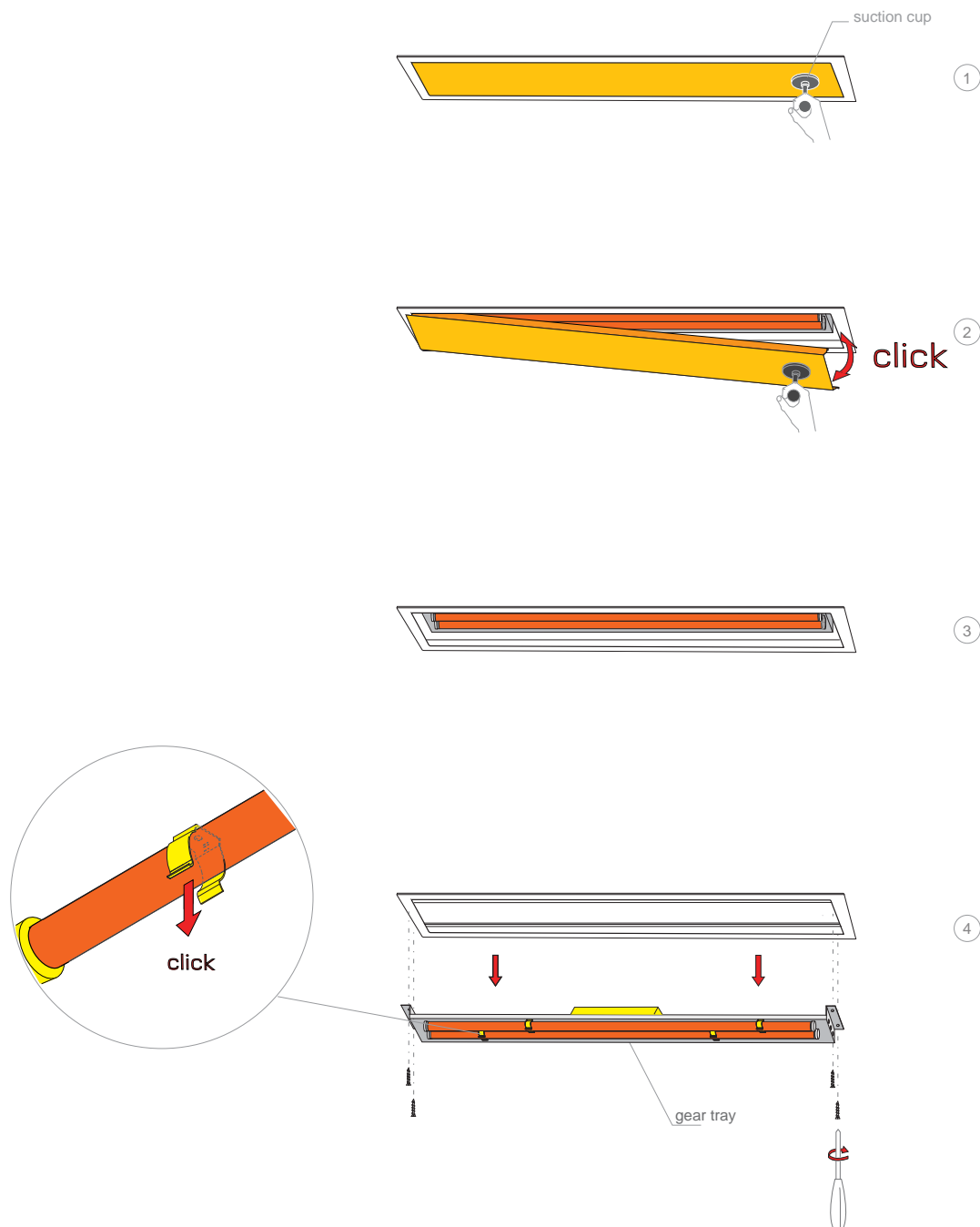

linear light application

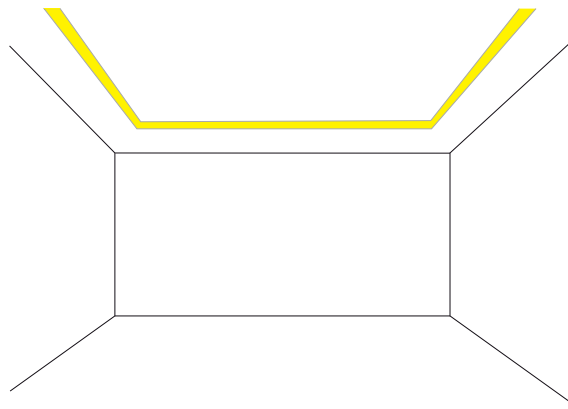

1. ceiling corner

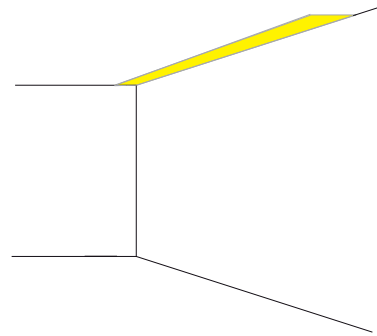

2. ceiling flush to wall

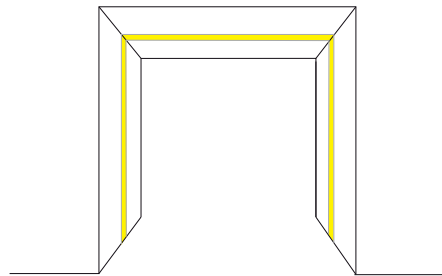

3. ceiling to wall corner

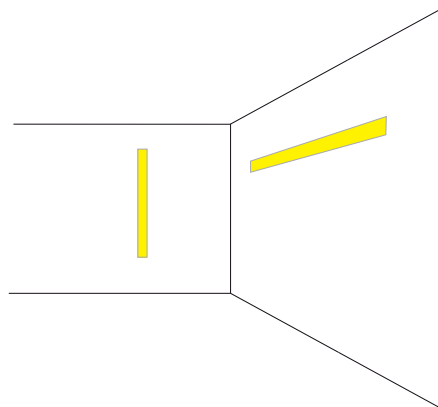

4. wall

Edgeless cove application

applications

The whitegoods edgeless cove system uniquely resolves decades of painstaking detailing by architects and designers. Not only does it remove the possibility of a poor finish (uneven upstands, wobbly edges, visible wires, shadow gaps and visible lamps), it also innovates. By creating a perfect crisp edge and an upstand that is invisible from most angles, the system elevates the humble edge light detail into an art form. All done with typical whitegoods attention to detail, the system is also simple to install. whitegoods: minimal, practical, functional.

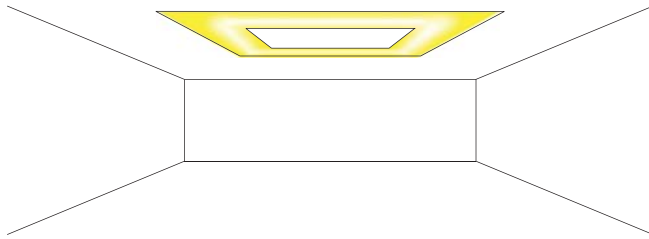

1. double sided linear light void with corners.

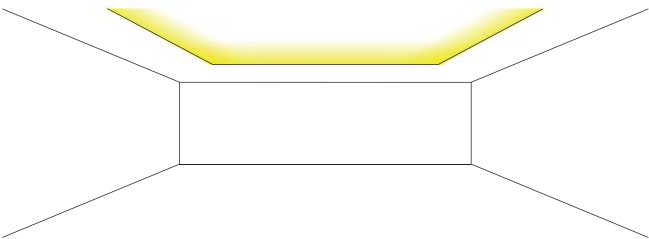
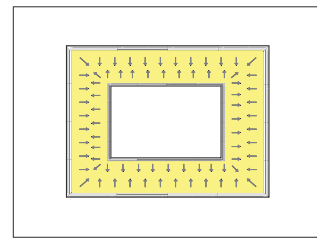

2. inward facing light void.

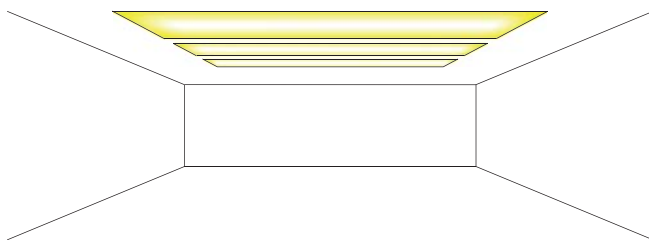
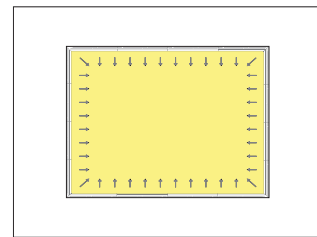

3. multiple double sided linear light void.

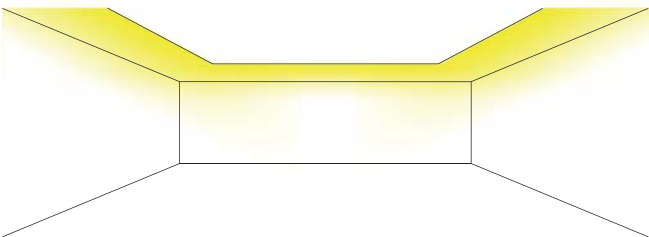
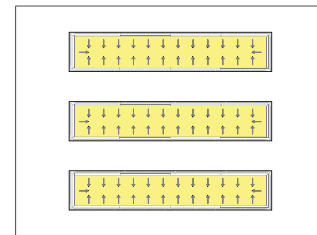

4. edge detail to create ceiling raft.

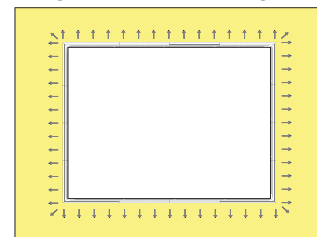

Z cove applications

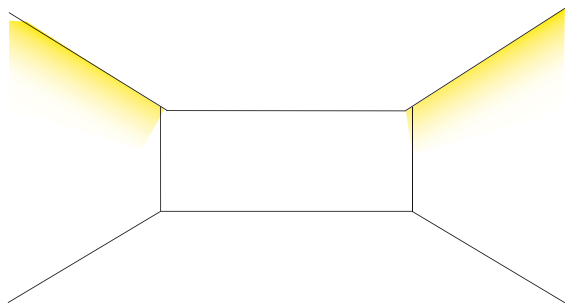

1. linear

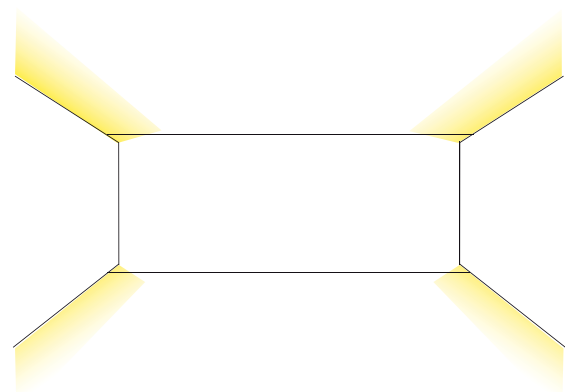
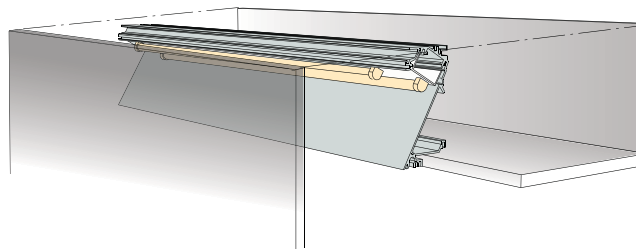

2. ceiling wash / floor wash

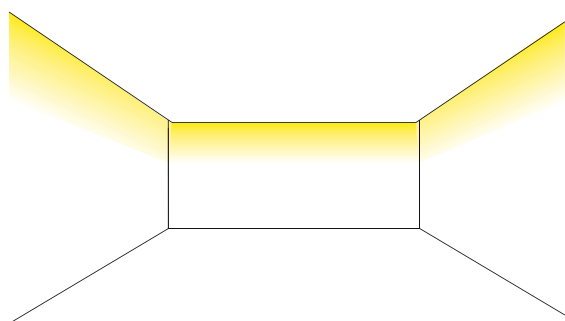
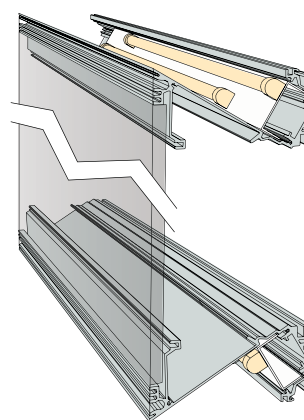

3. raft

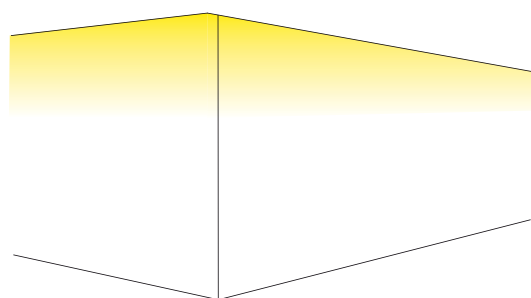
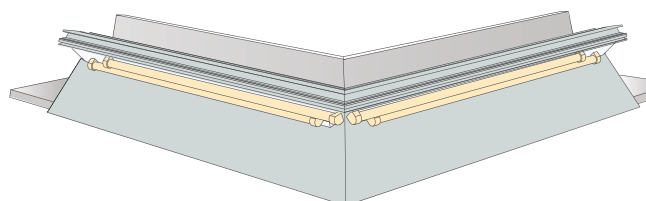

4. internal corner

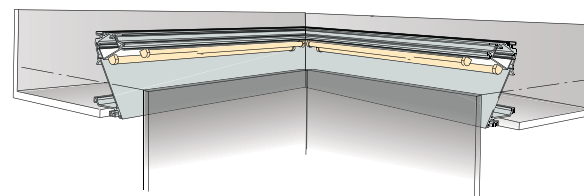

line of light applications

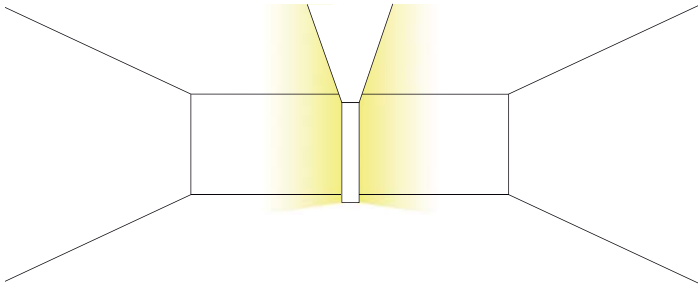

1. surface mounted
(wall + ceiling)

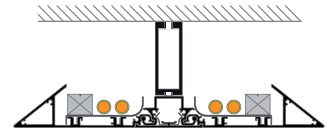

2. surface mounted
(wall)

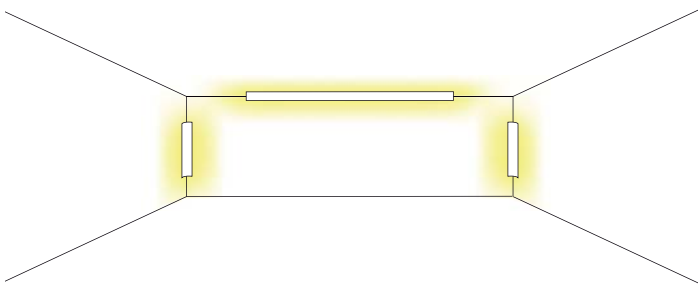
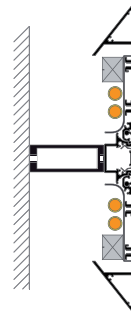

3. corner mounted
(wall/wall + ceiling/wall)

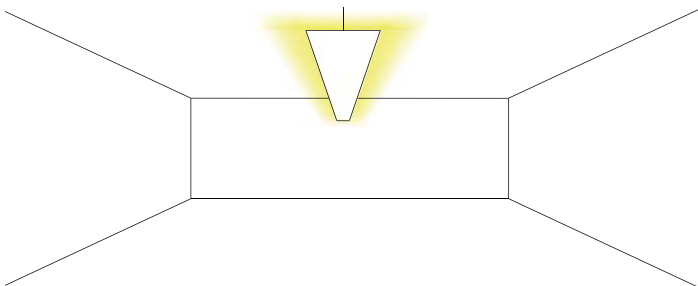
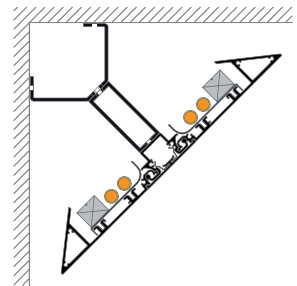

4. suspended (rod)

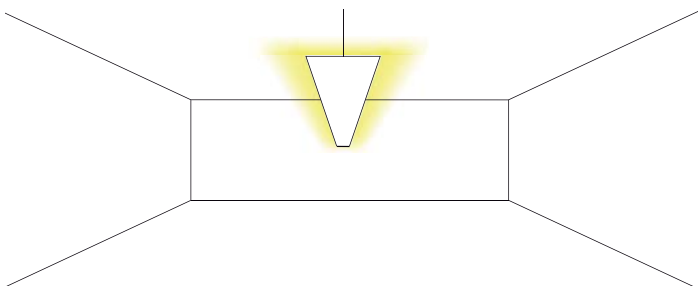
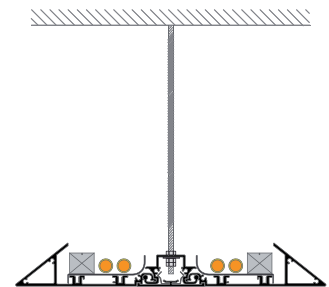

5. suspended (cable)

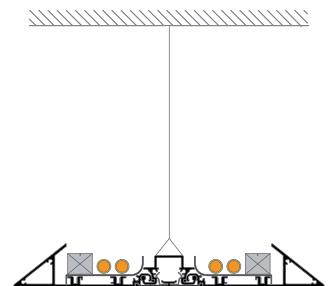

Linear 100-150 installation

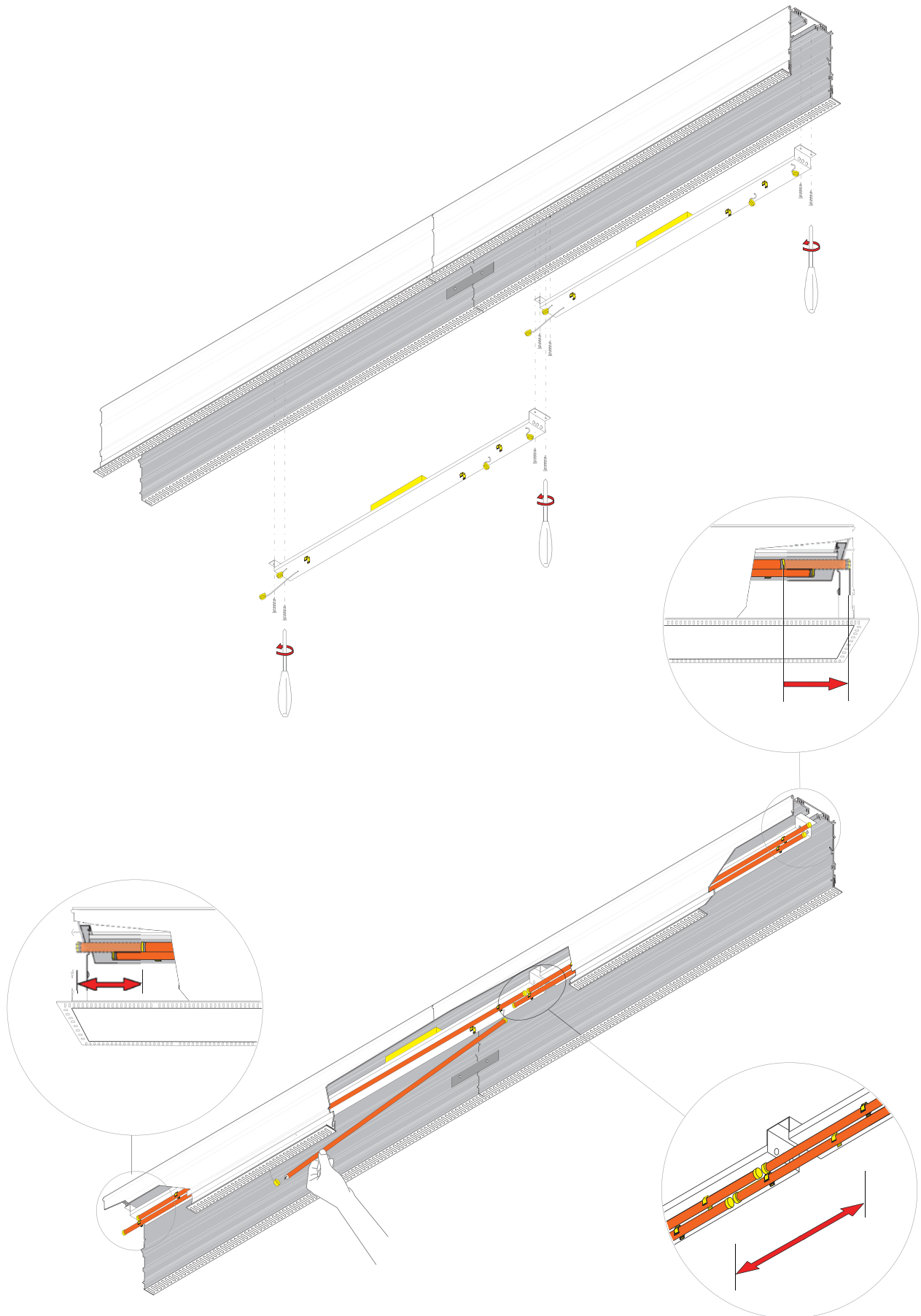

Linear 100-150 twin lamp overlapping configuration

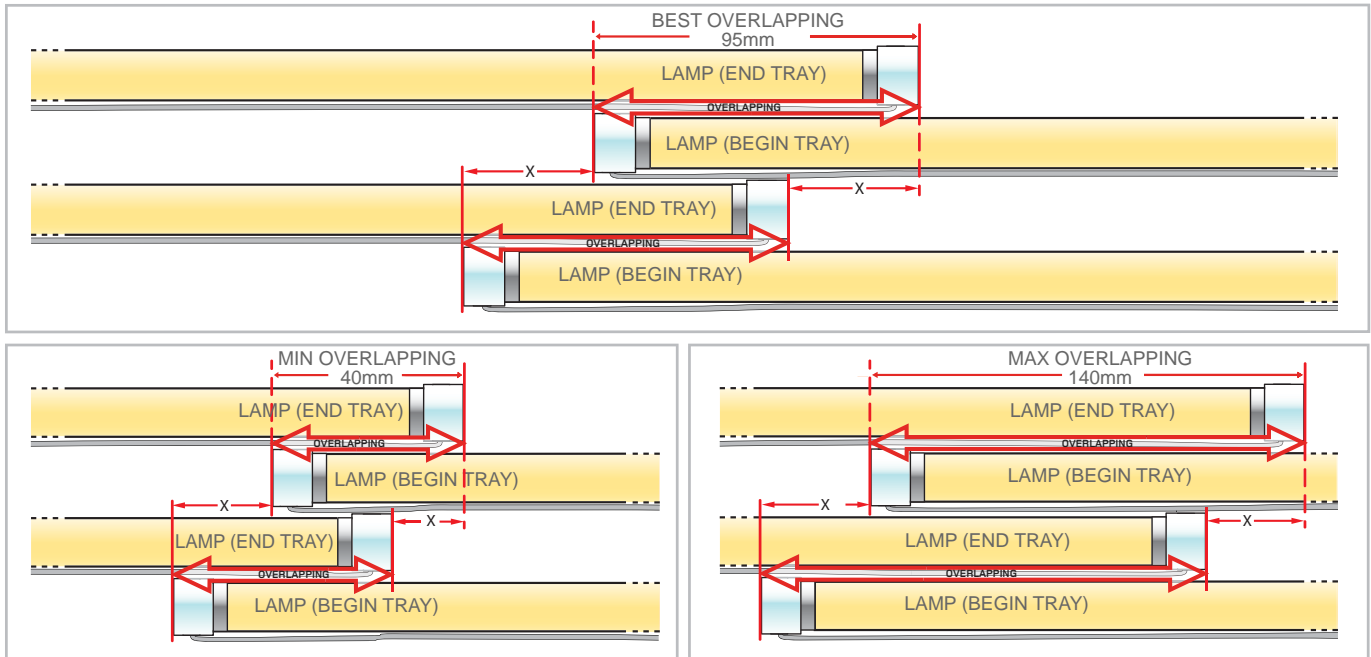

P150LDL6-214 - P100LDL6-214

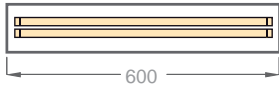

P150LDL9-221 - P100LDL9-221

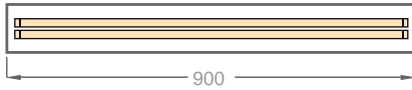

P150LDL12-228 - P100LDL12-228

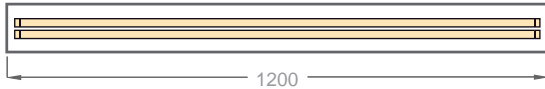

P150LDL15-235 - P100LDL15-235

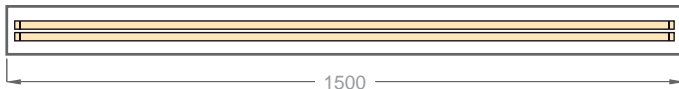

P150LDL18-421 - P100LDL18-421

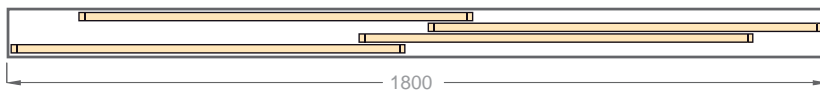

P150LDL24-428 - P100LDL24-428

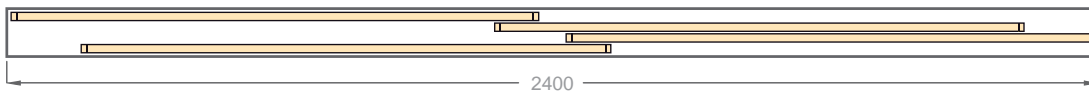

P150LDL30-435 - P100LDL30-435

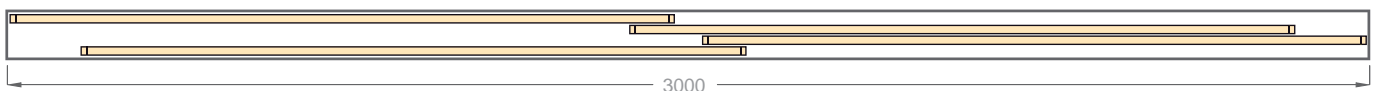

Linear 60 installation

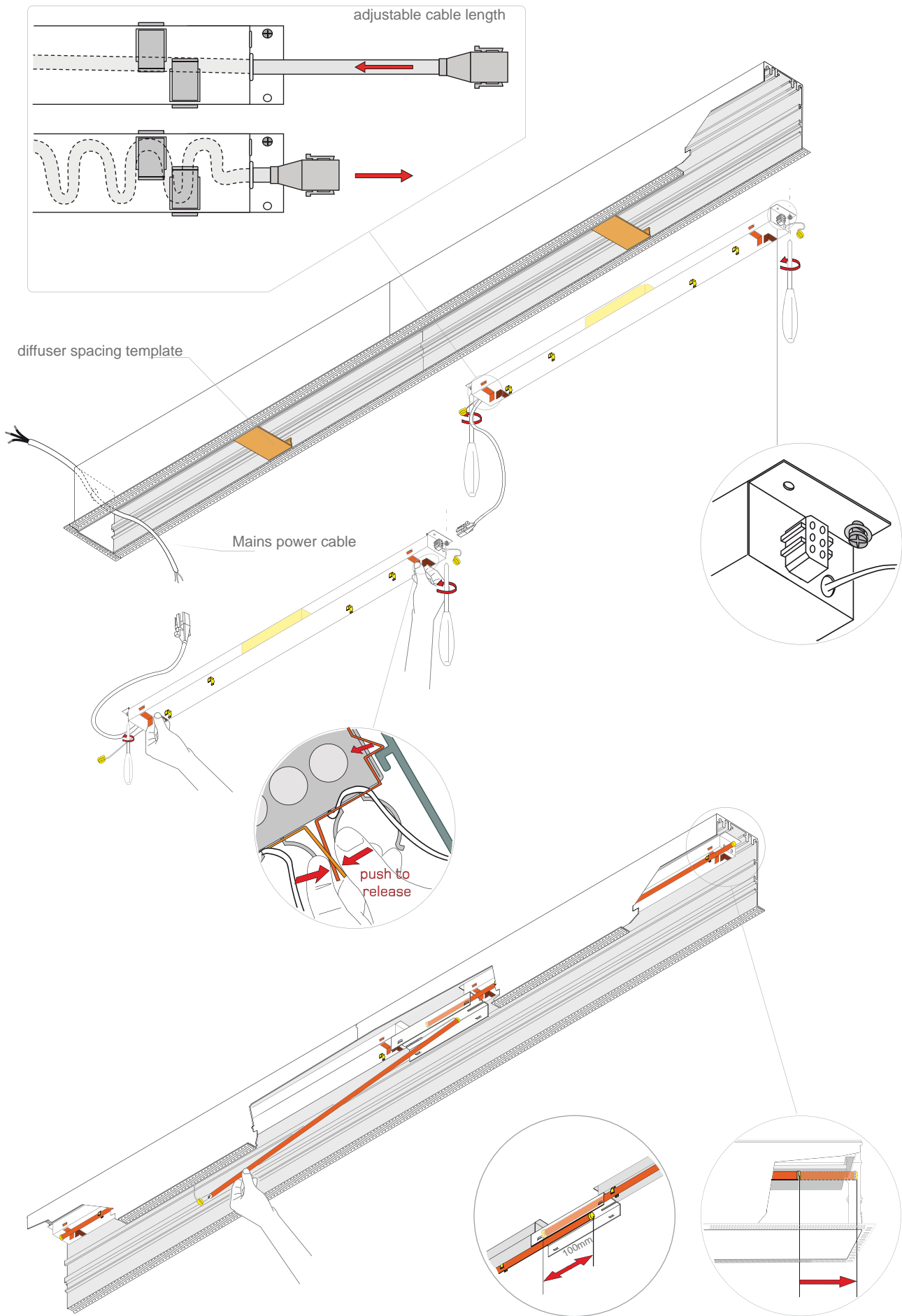

Linear 60 single lamp overlapping configuration

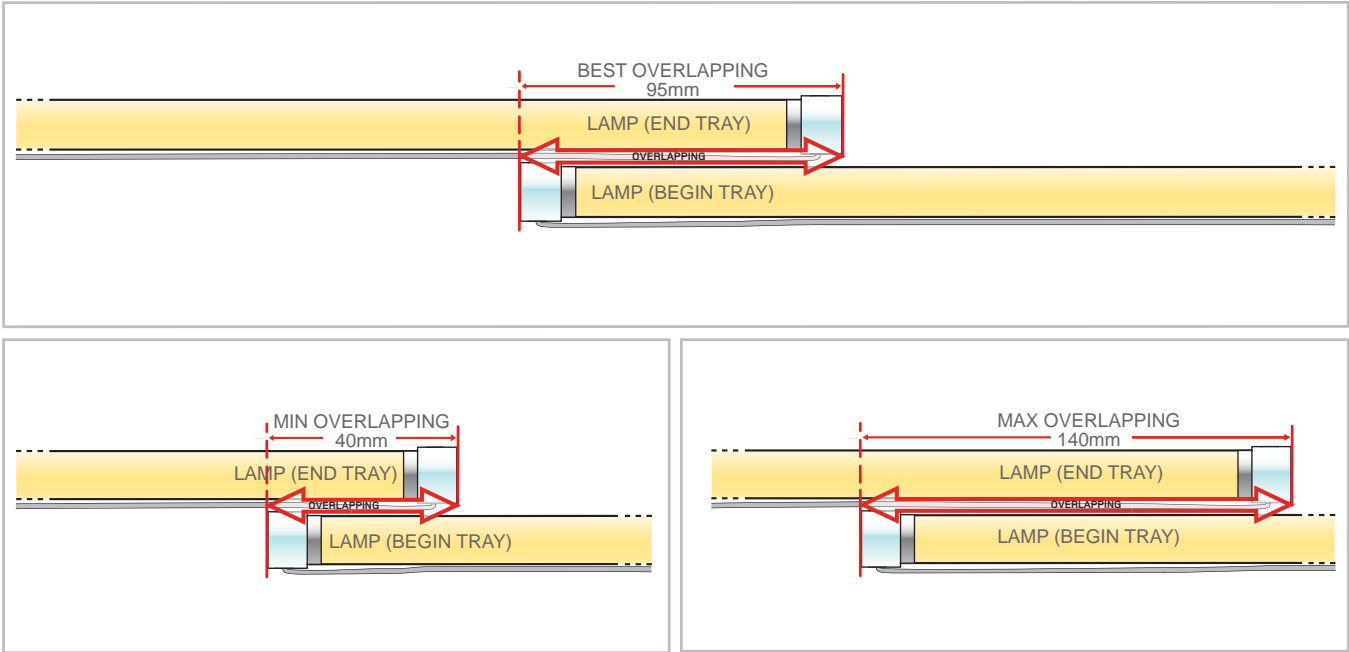

P60LDL6-114

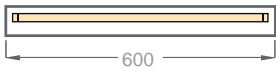

P60LDL9-121

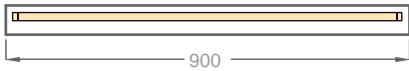

P60LDL12-128

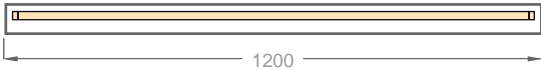

P60LDL15-135

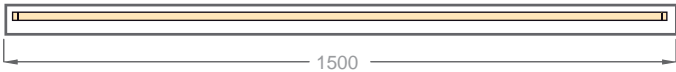

P60LDL18-1(14-21-14)



P60LDL24-321



P60LDL30-121-228



Z cove lamp configuration and installation

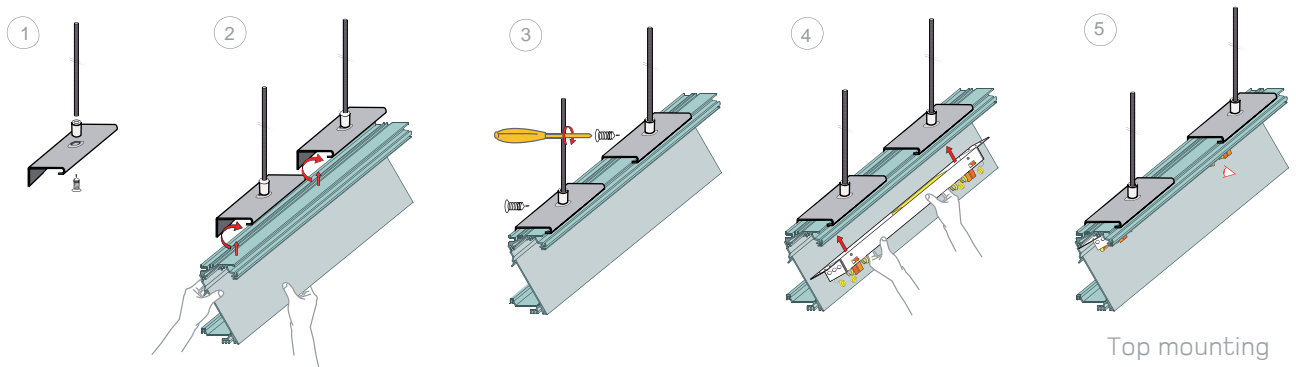
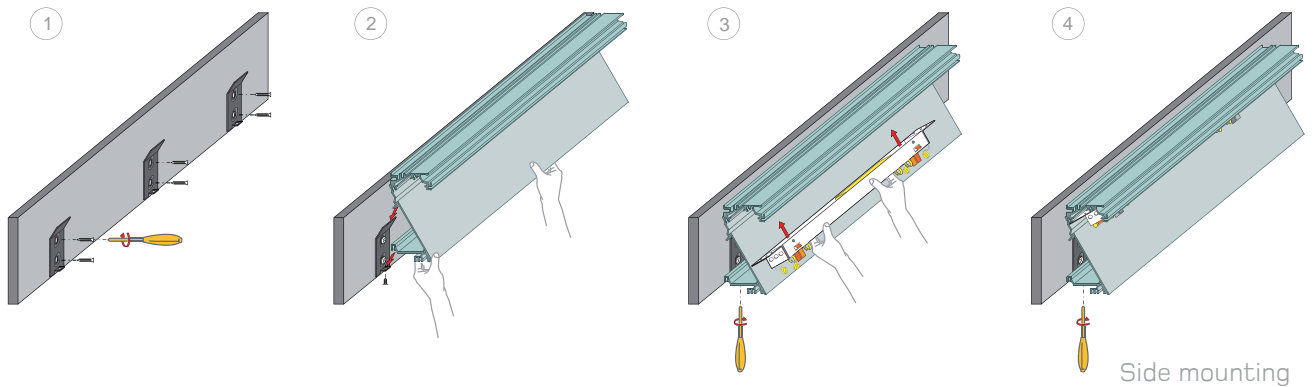
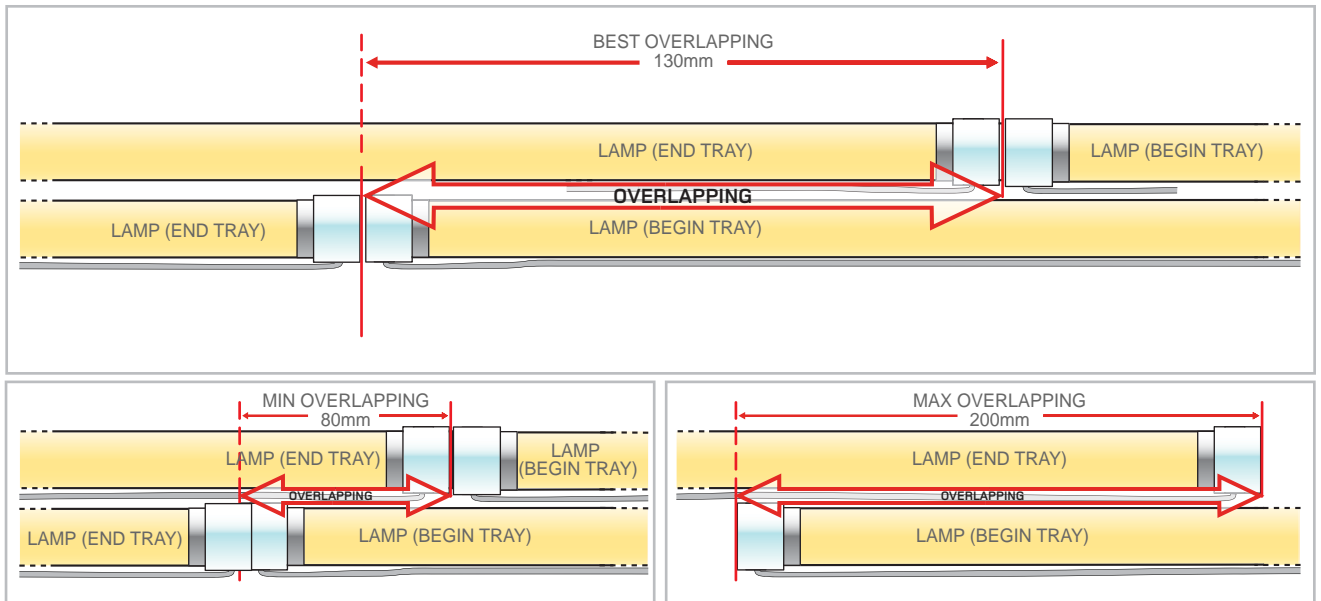

light strip lamp configuration and installation

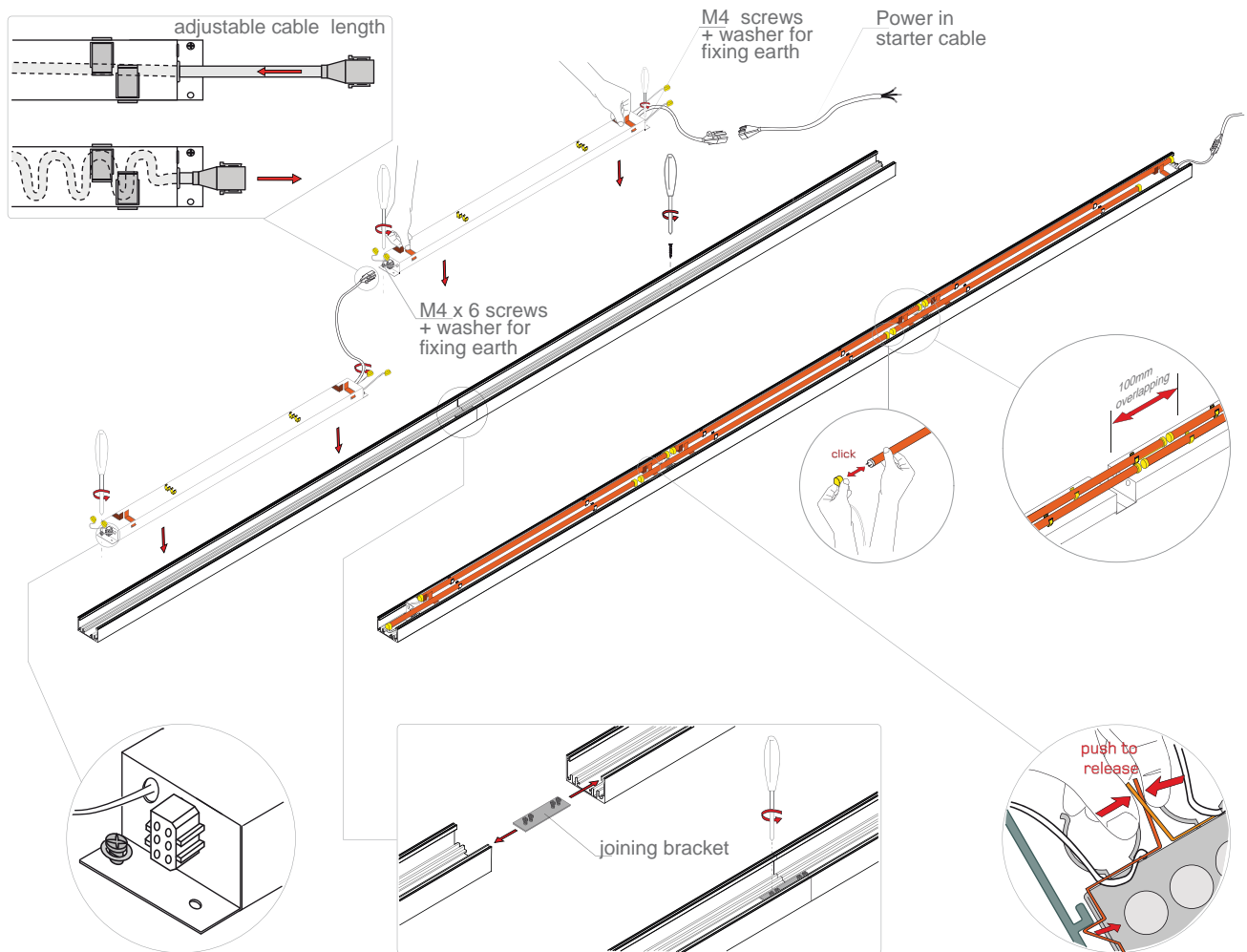
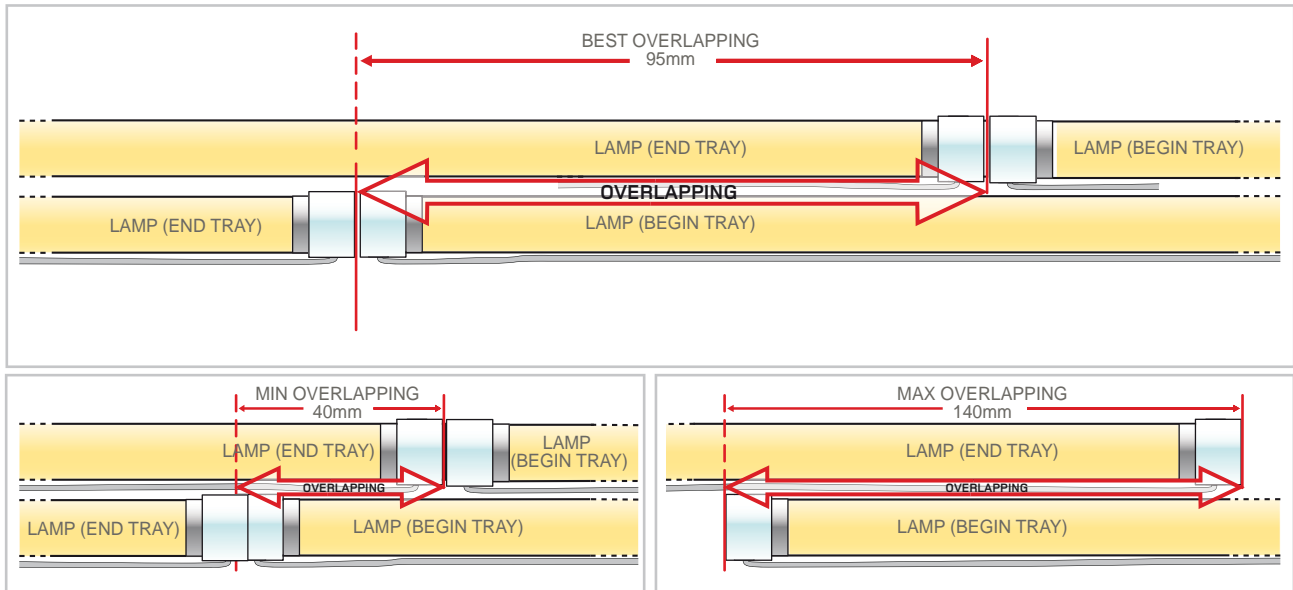

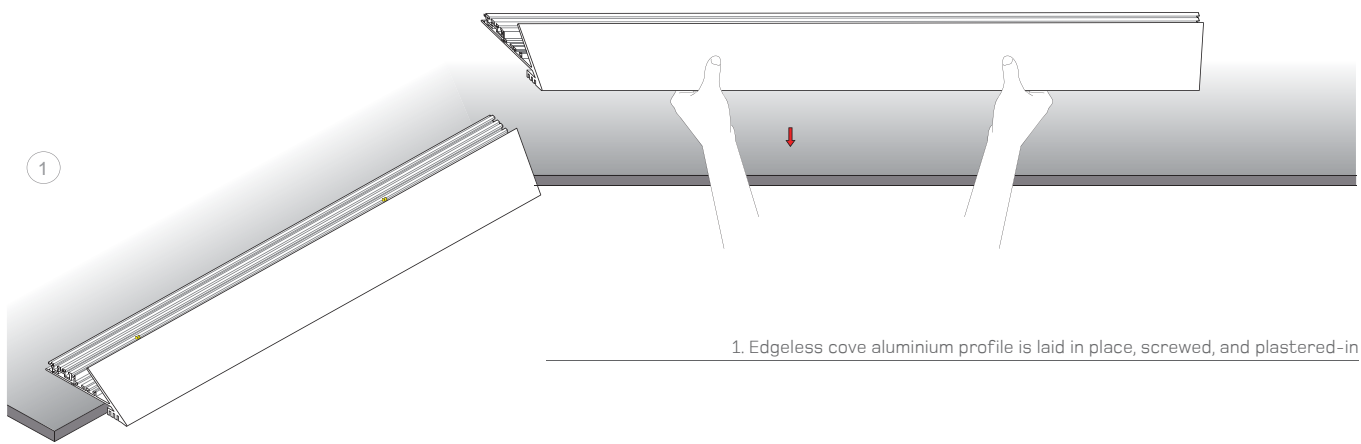

1. Edgeless cove aluminium profile is laid in place, screwed, and plastered-in

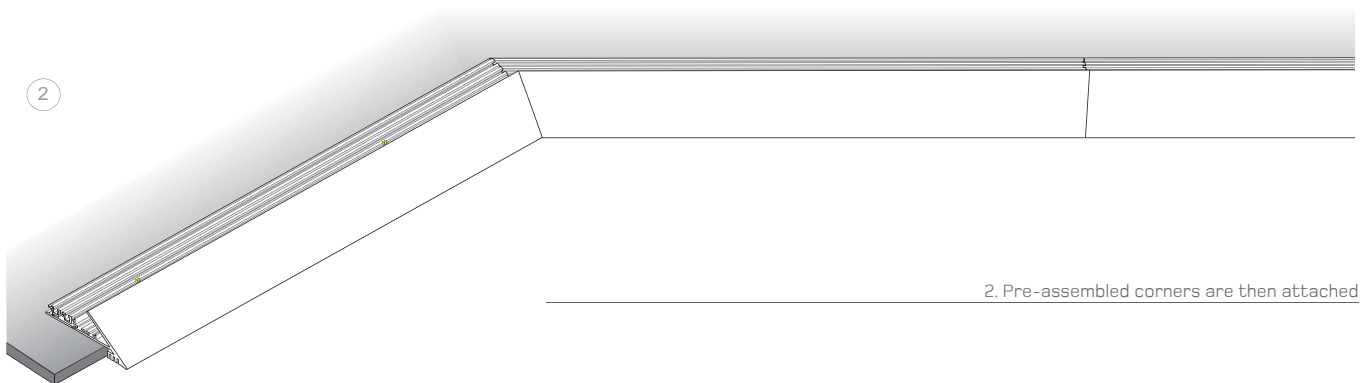

2. Pre-assembled corners are then attached

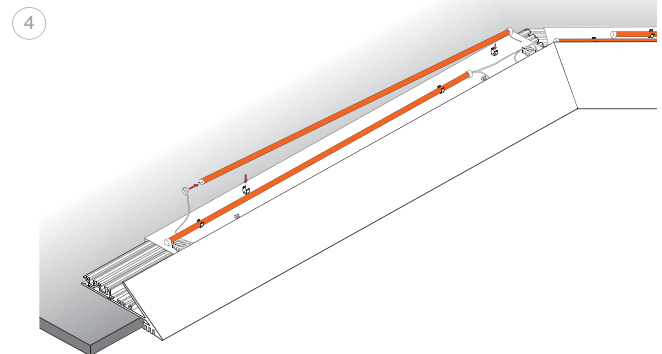
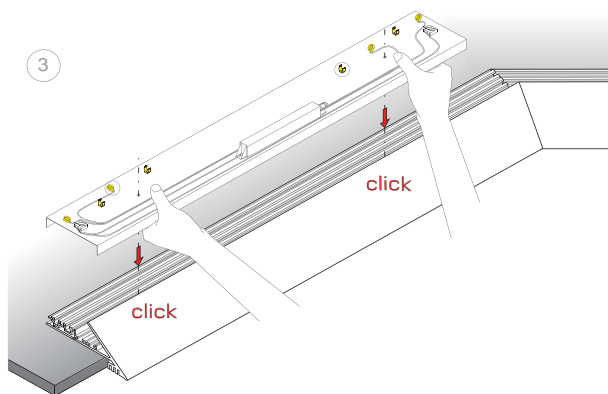

3,4. Second fix gear tray is fitted and in-line plugs connected

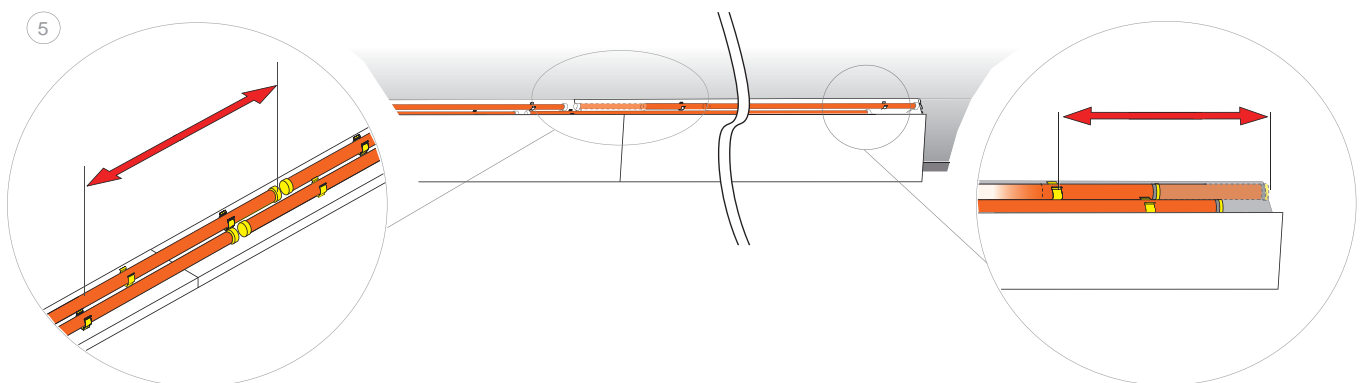

5. Lamps can be 'tuned' to achieve a continuous light effect

Edgeless Cove connection system

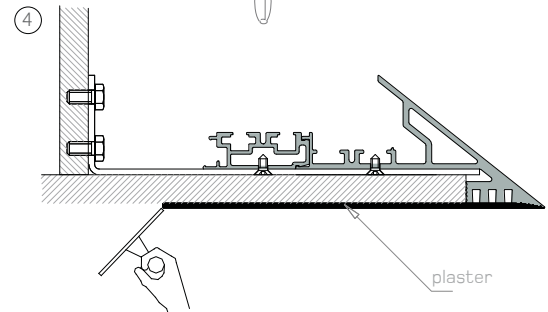
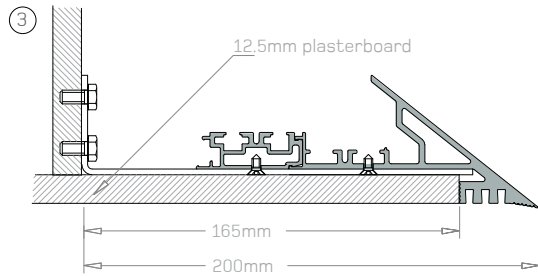
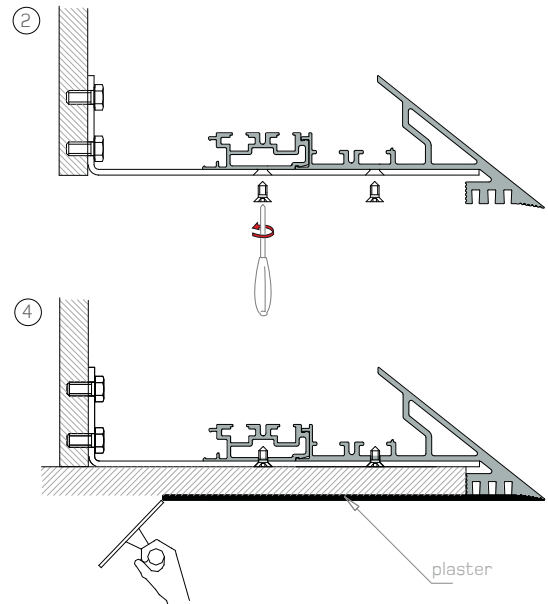
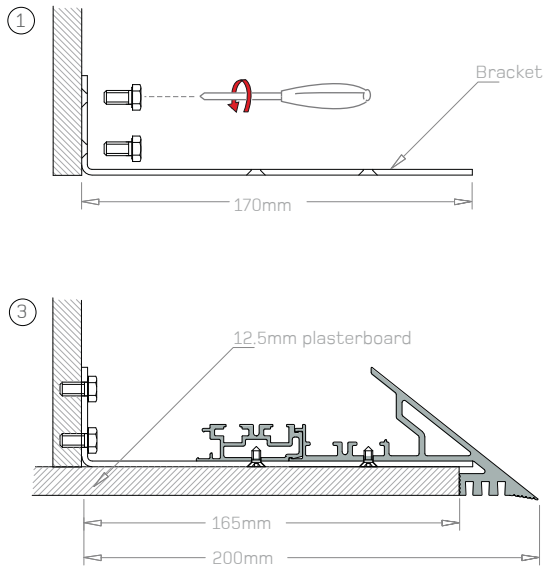

Edgeless Cove installation with bracket (optional)

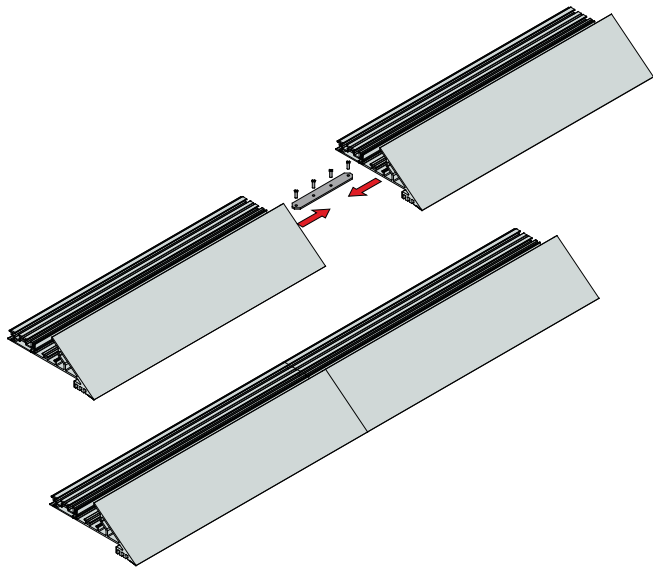

cove joint-connector for linear applications

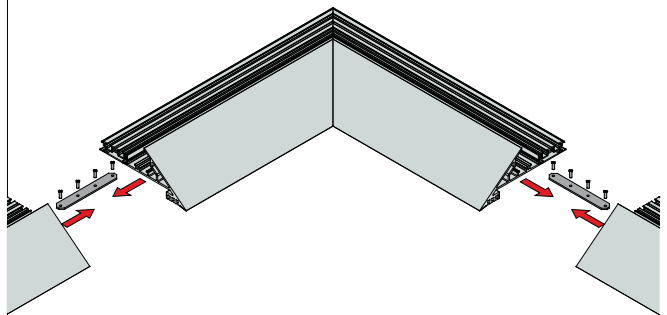

cove joint-connector for coffer applications

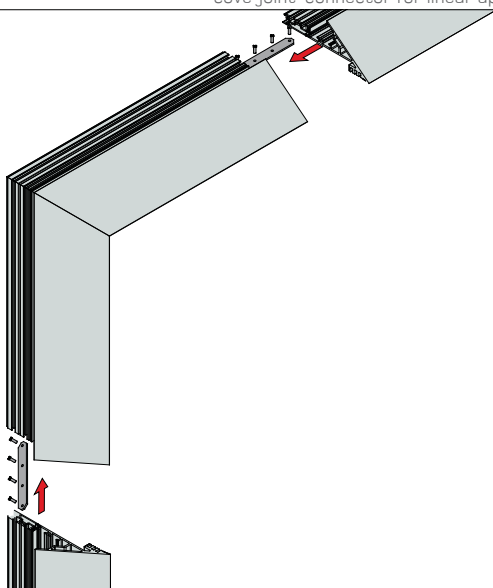

cove joint- connector for ceiling-wall applications

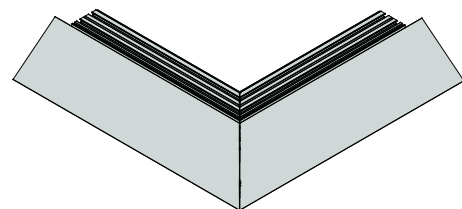

cove joint-connector for raft applications

Edgeless Cove lamp configuration

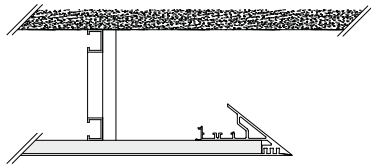

1. Nose only – Edgeless Cove can be purchased as an edge detail on its own without lighting

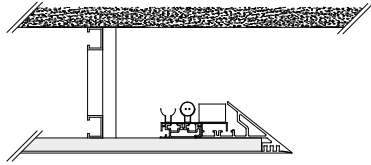

2. Plaster-in edgeless cove profile with single overlapping T5 lamps on a single circuit. Our most popular format.

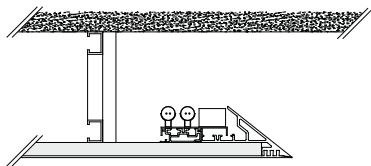

3. Plaster-in edgeless cove profile with twin overlapping T5 lamps on a single circuit (A), or two circuits (B) running warm (3000°K) and cool white lamps (4000°K)

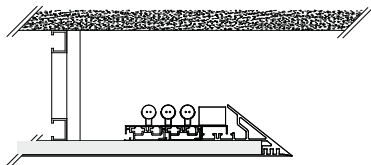
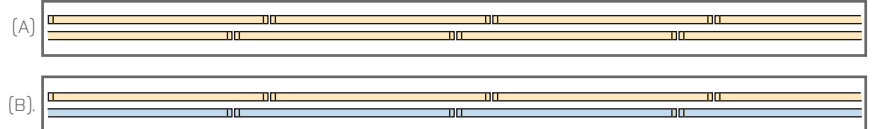

4. Plaster-in edgeless cove profile with three coloured T5 lamps (red, green & blue), wired through dimmable control gear and utilising a lighting control system.

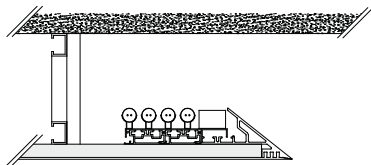
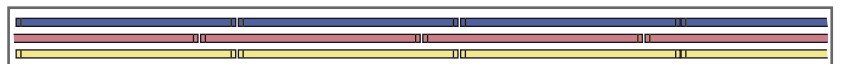

5. Plaster-in edgeless cove with two sets of twin overlapping T5 lamps. Each pair wired on a separate circuit. Often used to allow for separate switching or dimming between warm (3000°K) and cool lamps(4000°K)

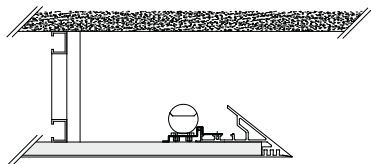
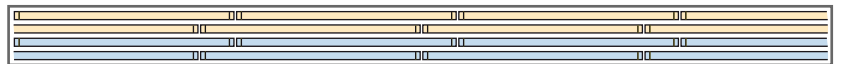

6. Plaster-in edgeless cove profile with a LED single circuit. Please contact us for further details on the LED system

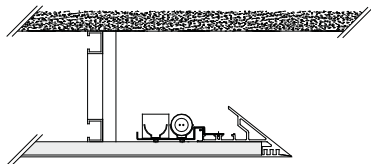

7. Plaster-in edgeless cove profile with twin overlapping encapsulated T5 lamps on a single circuit, allowing an IP66 rating. Please contact us for further details.

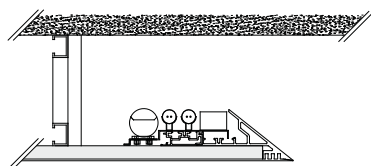

8. Plaster in edgeless cove profile with twin overlapping T5 lamps on a single circuit and a RGB LED colour changing system to allow for both fluorescent lighting and a colour changing system.

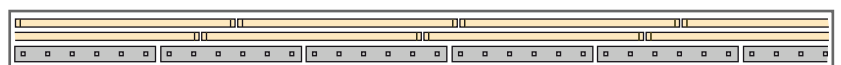

Edgeless Cove lamp configuration

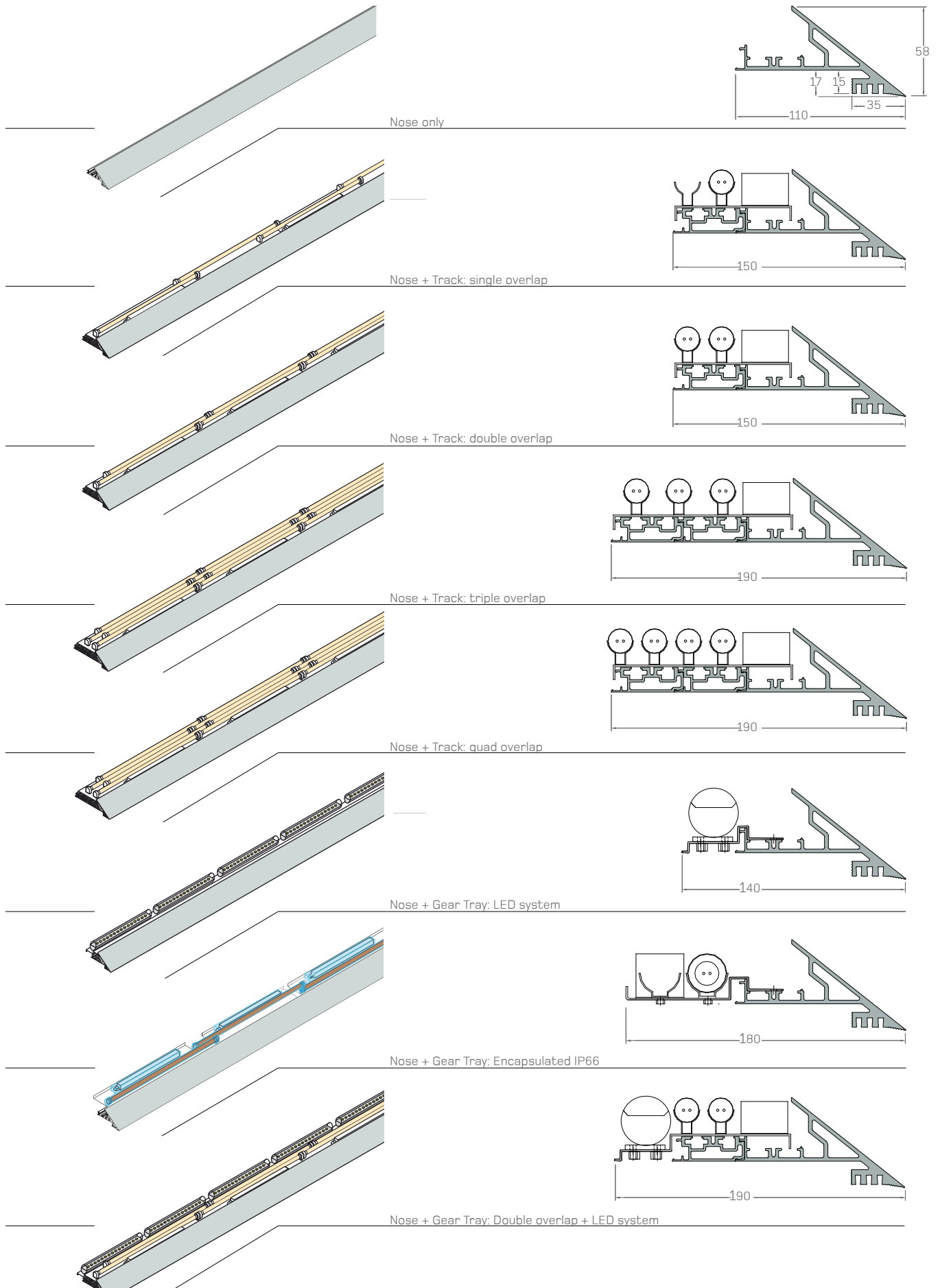

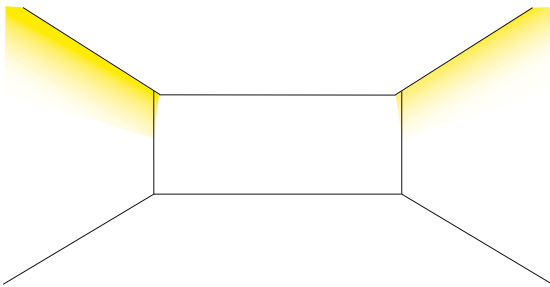
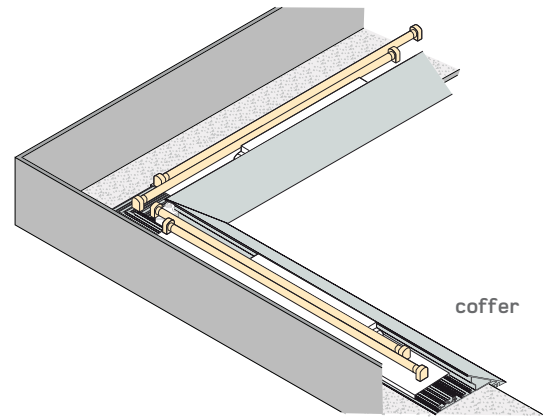
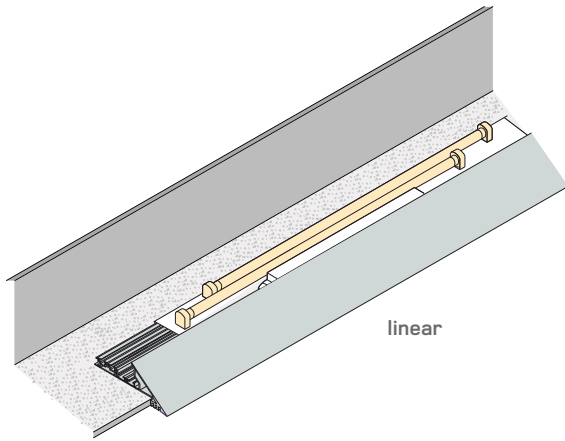

1. linear ceiling + wall

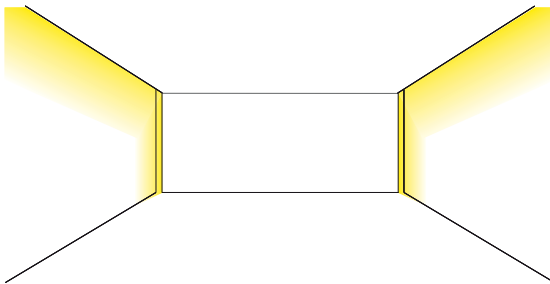
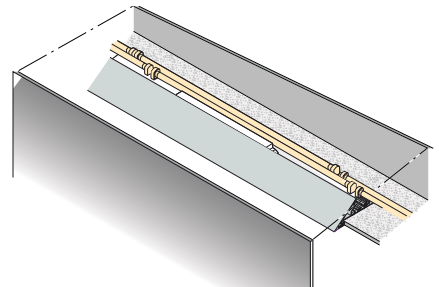

2. linear

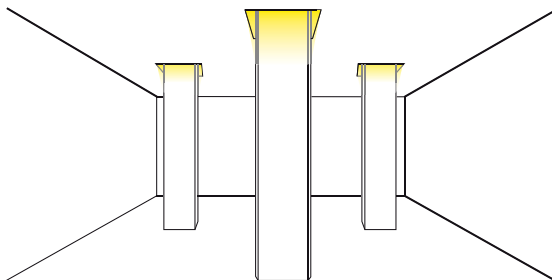
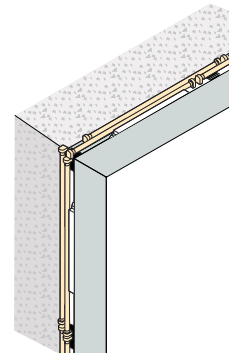

3. coffer (column surround)

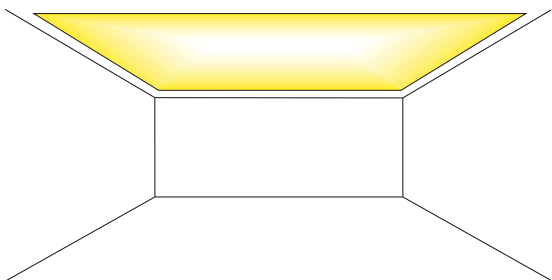
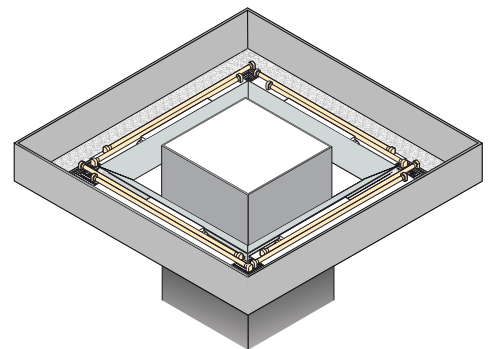

4. coffer

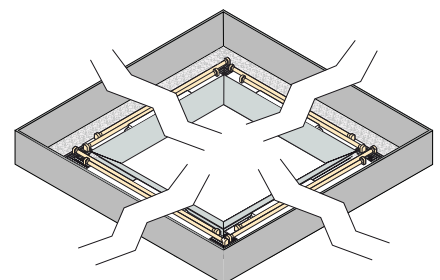

Edgeless Cove lamps configuration

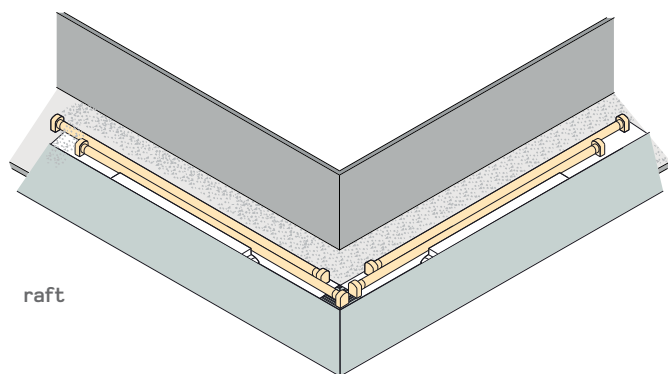

raft

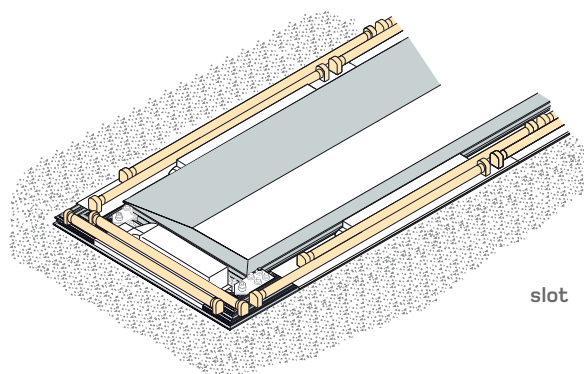

slot

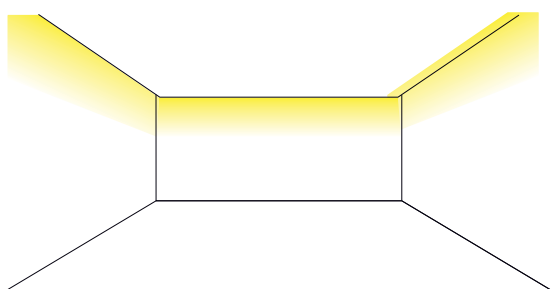

5. raft + coffer

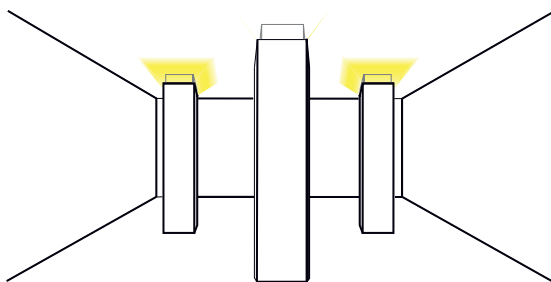
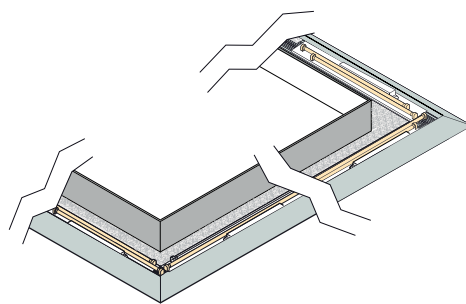

6. raft

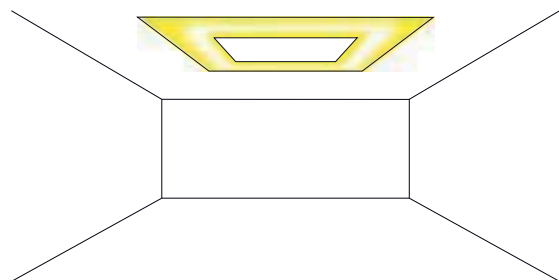
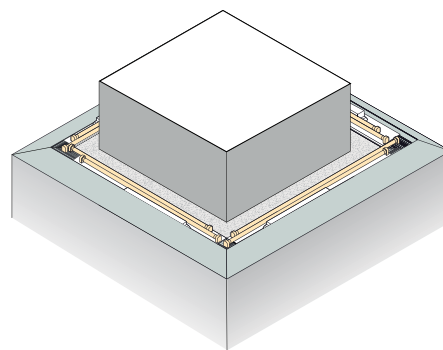

7. raft

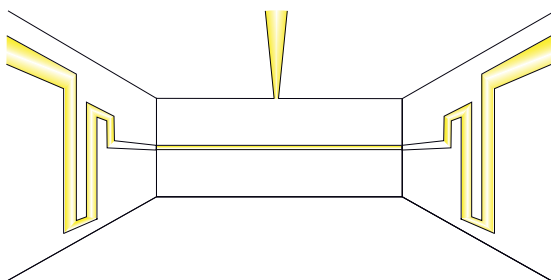
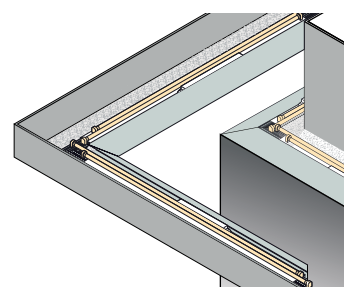

8. slot

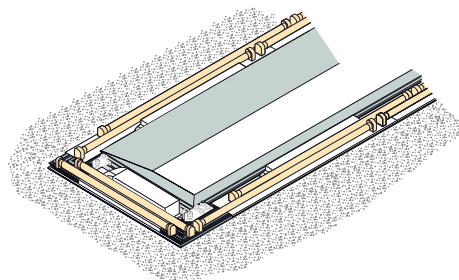

edgeless cove installation

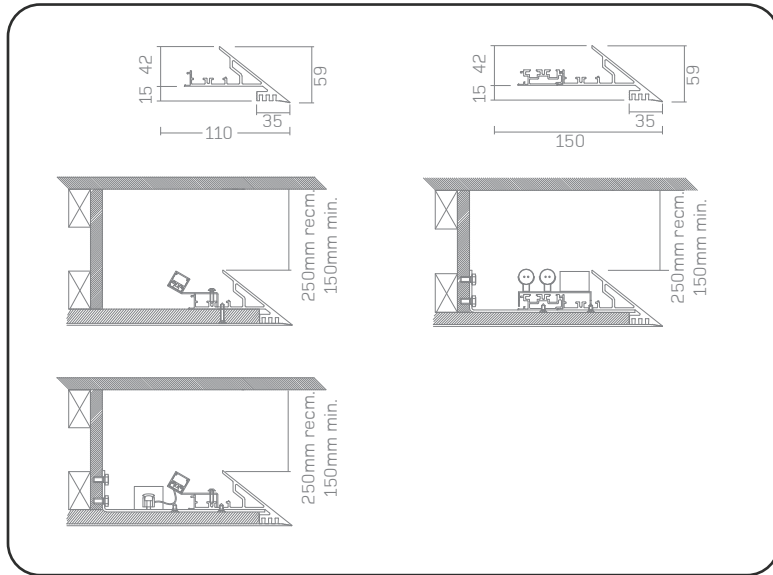

installation guide/
edgeless cove:

PEC
PECN
PECN-LED

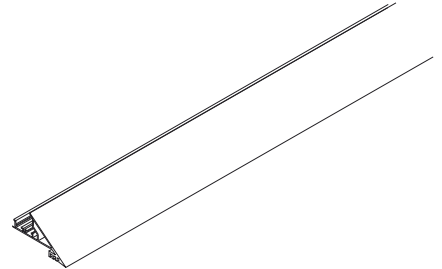

Installation with bracket (optional)

