

insert removal:
B60SDL; B60RDL

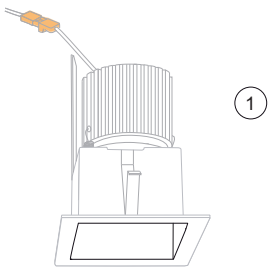

1

insert removal:
B60SDLIP; B60RDIP

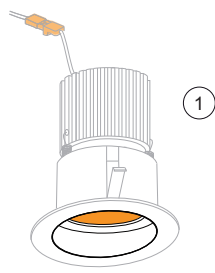

1

whitegoods

940-20044_R2

installation instructions / 60 bezel downlight:

B60SDL-LVR
B60SDL-LEDR/MVR
B60SDL-CDMR
B60SDL-LED-XI
B60SDL-LED-CL
B60SDLIP-LVR
B60SDLIP-MVR
B60SDLIP-CDMR
B60SDLIP-LED-XI
B60SDLIP-LED-CL

B60RDL-LVR
B60RDL-LEDR/MVR
B60RDL-CDMR
B60RDL-LED-XI
B60RDL-LED-CL
B60RDIP-LVR
B60RDIP-MVR
B60RDIP-CDMR
B60RDIP-LED-XI
B60RDIP-LED-CL

lamp position

Lamp is regressed 30mm as standard. For flush glass order separate accessory. Unavailable for IP fittings.

IP frame designed fo 12.5mm plaster thickness

cut-out:
70mm x 70mm
cut-out IP:
78mm x 78mm

cut-out:
Ø 70mm
cut-out IP:
Ø 75mm

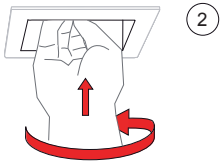

2

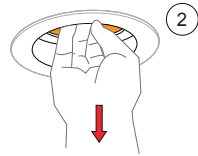

2

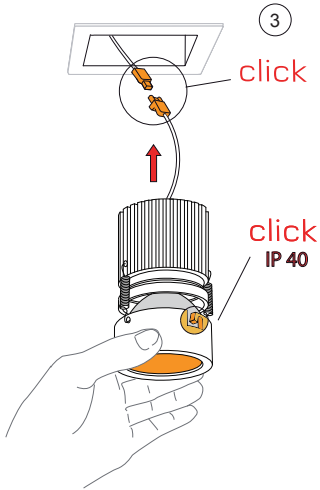

3

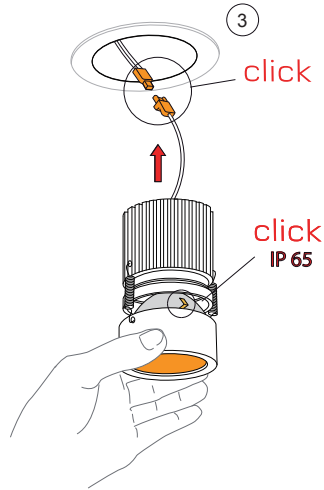

3

standard / IP 65

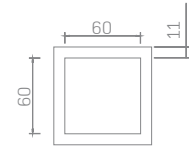
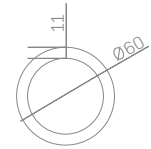
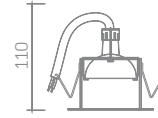
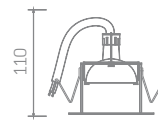

Recess depth required for LVR & MVR lamps is 110mm

Standard LED heatsink

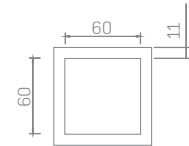
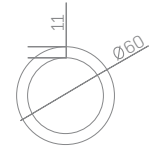
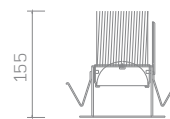
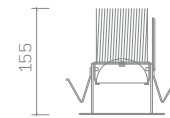

Reduced depth LED heatsink

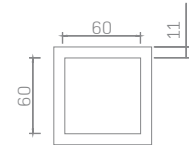
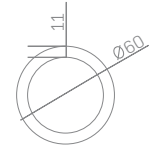
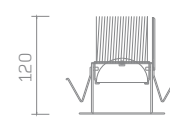

Recess depth required for all integral CMH, CDMR and LED lamps is 170mm
Recess depth required for emergency lamps is 200mm

lamp removal

Contact whitegoods at end of LED lamp life
(projected lifetime of LED is 50,000hrs)

Replacing all other lamp types follow step 4 and 5.

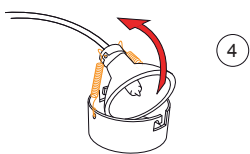

4

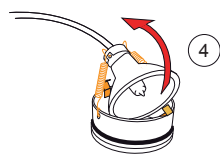

4

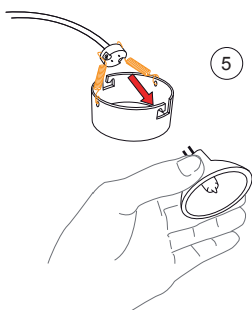

5

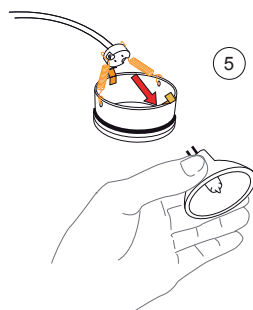

5



0,5m



Registration number is WEE/FG0362QY

whitegoods

installation instructions / 60 bezel downlight:

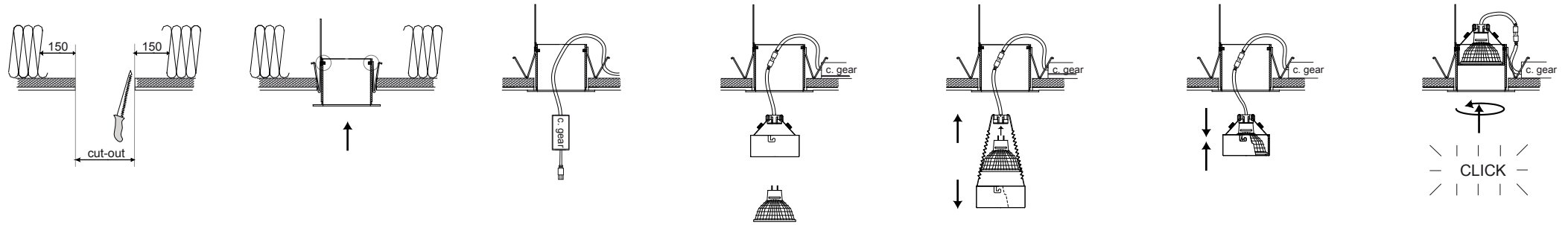

B60SDL; B60RDL

B60SDL-LVR
B60SDL-LEDR/MVR
B60SDL-CDMR
B60SDL-LED-XI
B60SDL-LED-CL

B60RDL-LVR
B60RDL-LEDR/MVR
B60RDL-CDMR
B60RDL-LED-XI
B60RDL-LED-CL

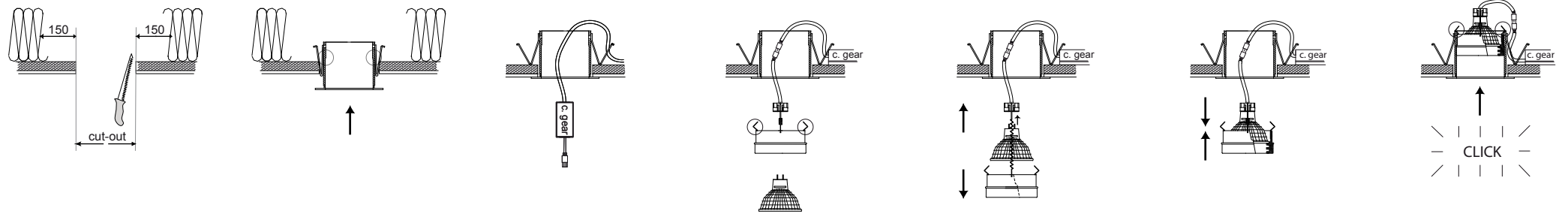

B60SDLIP; B60RDLIP

B60SDLIP-LVR
B60SDLIP-LEDR/MVR
B60SDLIP-CDMR
B60SDLIP-LED-XI
B60SDLIP-LED-CL

B60RDLIP-LVR
B60RDLIP-LEDR/MVR
B60RDLIP-CDMR
B60RDLIP-LED-XI
B60RDLIP-LED-CL



Registration number is WEE/FG0362QY