

<div>inter•lux</div>		<div>Box Cove</div> <div>INSTALLATION INSTRUCTIONS</div>	WEIGHT:	FINISH: White (Standard)	WG BC-SM
<div><div><div></div></div><div>WARNING:</div></div> <div>INSTALL PRODUCT IN ACCORDANCE WITH LOCAL AND NATIONAL ELECTRICAL CODES BY A QUALIFIED ELECTRICIAN OR ELECTRICAL CONTRACTOR.</div>	<div><div><div></div></div><div>WARNING:</div></div> <div>FAILURE TO COMPLY WITH THE INSTALLATION INSTRUCTIONS MAY RESULT IN DEATH OR SERIOUS INJURY</div>	<div><div><div></div></div><div>WARNING:</div></div> <div>READ ALL SAFETY INSTRUCTIONS INCLUDED WITH LUMINAIRE BEFORE INSTALLING LUMINAIRE.</div>	<div>CAUTION:</div> <div>THIS IS AN ELECTRONIC DEVICE. CARE MUST BE TAKEN DURING STORAGE AND HANDLING. STORE IN A CLEAN, COOL AND DRY LOCATION. ELECTROSTATIC DISCHARGE (ESD) CAN HARM THIS PRODUCT. AVOID STATIC DISCHARGE WHILE HANDLING THIS PRODUCT.</div>		<div>CAUTION:</div> <div>INTER-LUX IS NOT RESPONSIBLE FOR THE STRUCTURAL INTEGRITY OF THE BUILDING TO SUPPORT THE LUMINAIRE. ADDITIONAL BACKING MAY BE REQUIRED.</div>

ISOMETRIC VIEWS

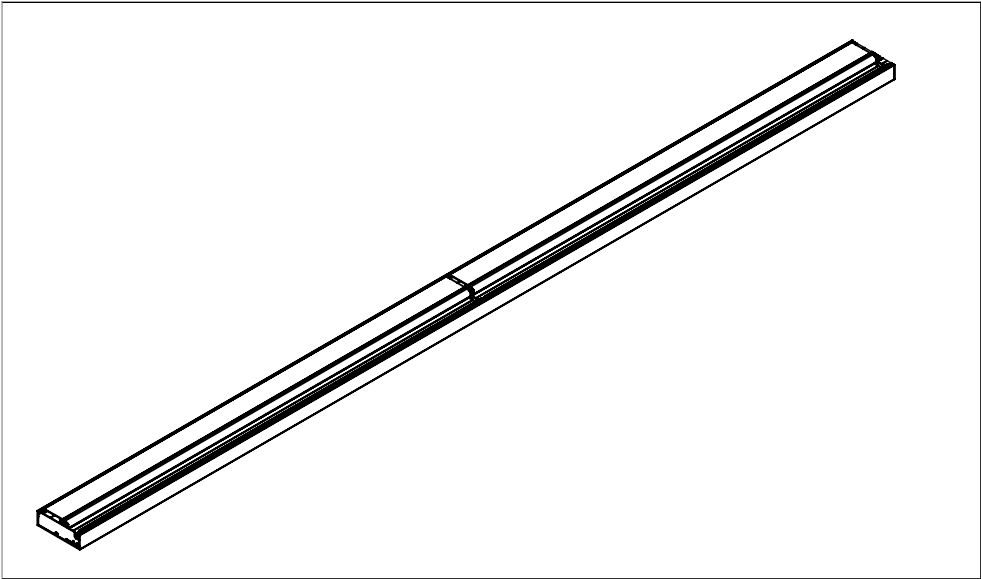

MOUNTING DIMENSIONS

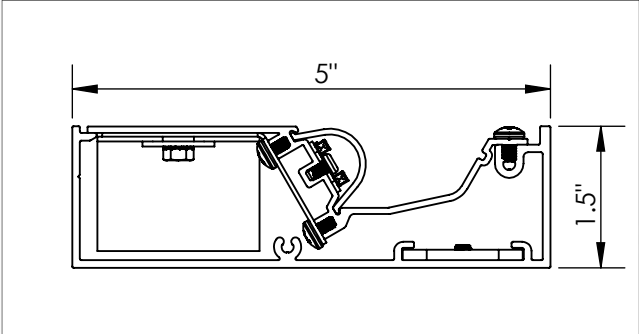

MOUNTING OPTIONS

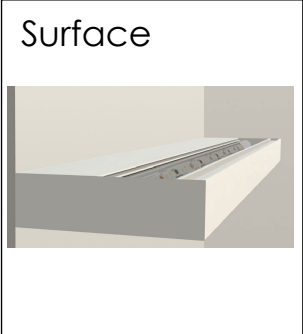

PACKAGE MAY INCLUDE: (refer to package list to identify parts)

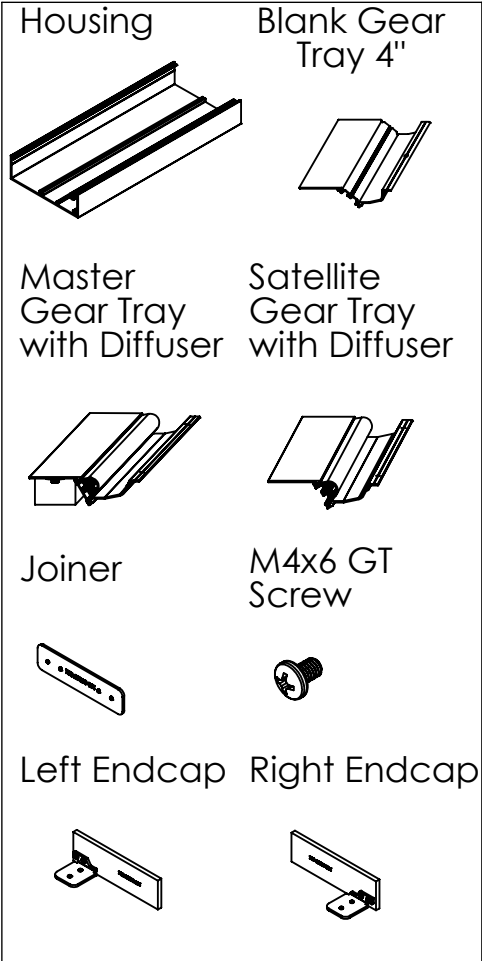

ITEMS NEEDED (SUPPLIED BY OTHERS):

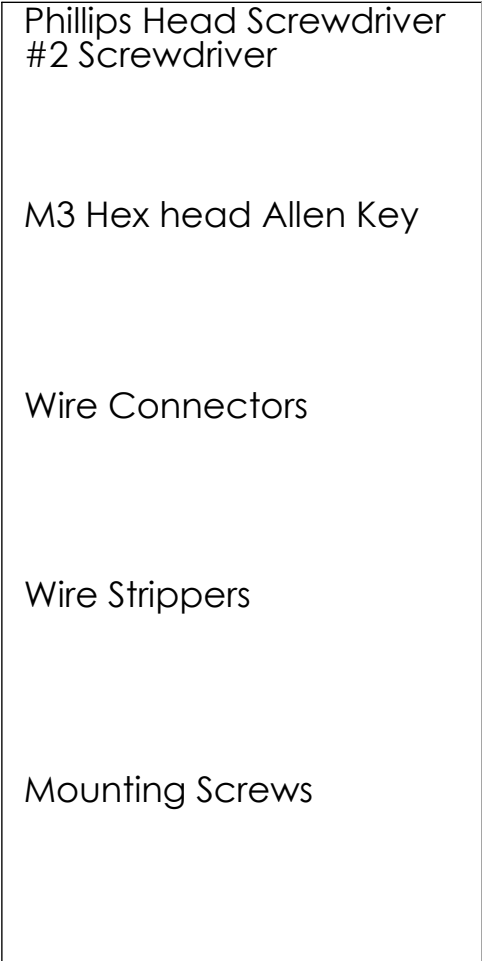

INSTALLATION INSTRUCTIONS

LOCATE AND REVIEW ANY CONSTRUCTION PLANS AND INTERLUX RECORD DRAWINGS FOR ALL FIXTURE RUNS. It is recommended to locate and lay out all components for each fixture "run". A fixture run typically consist of joiners, lengths of housings, lengths of gear trays with diffuser(satellite and master), blank gear trays, and endcaps. BE SURE TO IDENTIFY ALL CORRECT LENGTHS FOR EACH FIXTURE RUN.

Step 1: Turn off Power before Installing.

Mount housing extrusion to the mounting surface at desired height with fasteners. Surrounding structure is required to support the weight of the fixture. (Recommended: start at end wall for linear fixtures or corner for rectangular and U-shapes.)

Surface Application

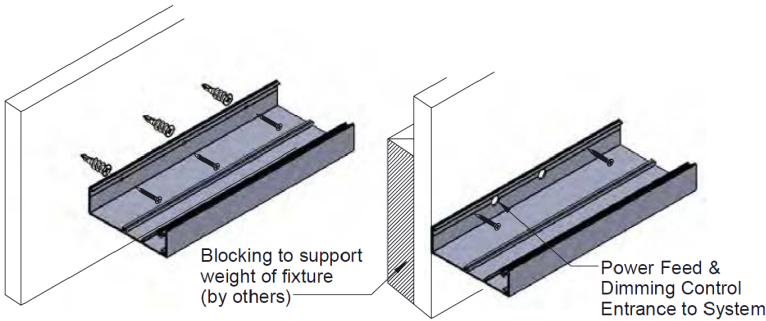

Lay-in Cove application

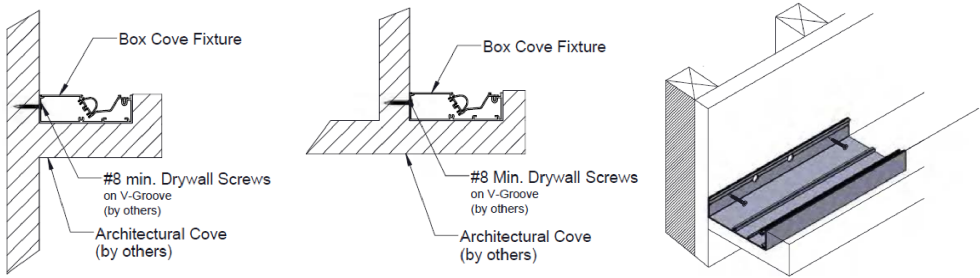

Step 2:(If single housing skp this step) Mount next housing extrusion as shown by sliding the provided joiner into the adjacent housing. Secure in place by tightening set screws. Mount housing to structure. Repeat this step until all housings are installed and mounted.

Surface Application

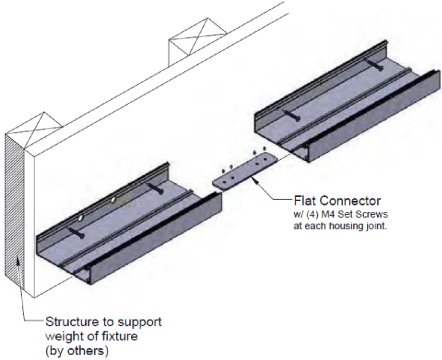

Lay-in Cove application

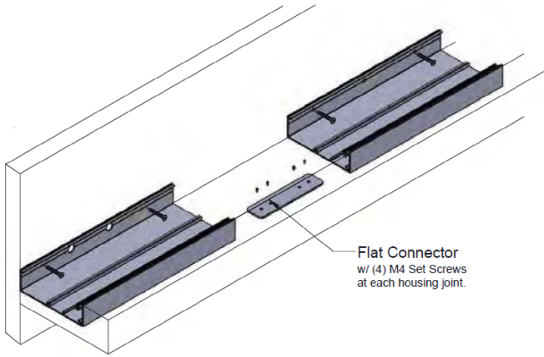

Step 3: (If no endcaps skip this step) Install endcaps on ends of first and last housing.

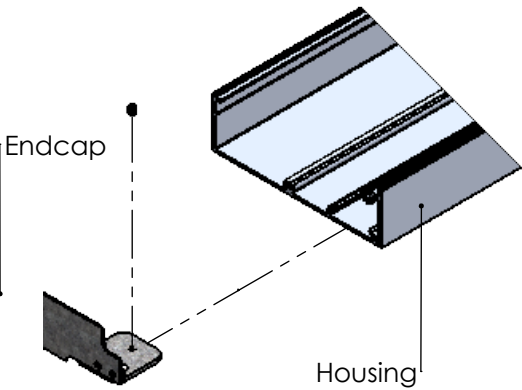

Step 4: Install Gear Trays making electric connections first, then insert gear tray into housing. Refer to pages 2&3 for wiring diagrams if needed. Refer to record drawings for gear tray placement. Secure gear tray to housing using screws in pre-drilled holes. Repeat this step until all gear trays are installed. Energize and test for proper operation.

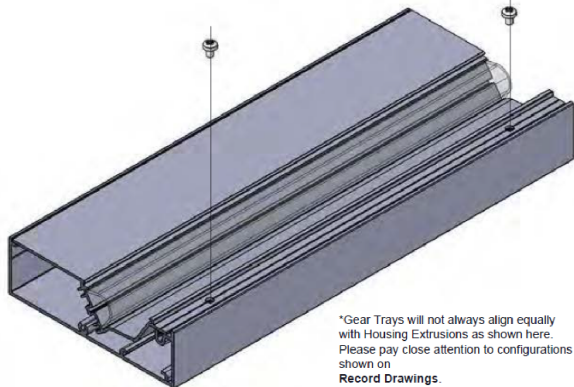
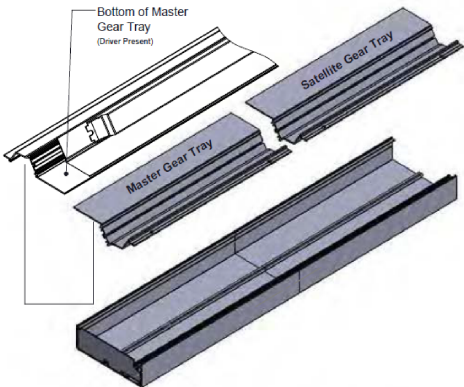

*Gear Trays will not always align equally with Housing Extrusions as shown here. Please pay close attention to configurations shown on Record Drawings.

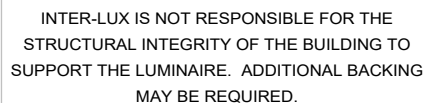

<div>inter•lux</div>		<div>Box Cove</div> <div>INSTALLATION INSTRUCTIONS</div>	WEIGHT:	FINISH: White (Standard)	WG BC-SM
<div><div><div></div></div><div>WARNING:</div><div>INSTALL PRODUCT IN ACCORDANCE WITH LOCAL AND NATIONAL ELECTRICAL CODES BY A QUALIFIED ELECTRICIAN OR ELECTRICAL CONTRACTOR.</div></div>	<div><div><div></div></div><div>WARNING:</div><div>FAILURE TO COMPLY WITH THE INSTALLATION INSTRUCTIONS MAY RESULT IN DEATH OR SERIOUS INJURY</div></div>	<div><div><div></div></div><div>WARNING:</div><div>READ ALL SAFETY INSTRUCTIONS INCLUDED WITH LUMINAIRE BEFORE INSTALLING LUMINAIRE.</div></div>	<div>CAUTION:</div> <div>THIS IS AN ELECTRONIC DEVICE. CARE MUST BE TAKEN DURING STORAGE AND HANDLING. STORE IN A CLEAN, COOL AND DRY LOCATION. ELECTROSTATIC DISCHARGE (ESD) CAN HARM THIS PRODUCT. AVOID STATIC DISCHARGE WHILE HANDLING THIS PRODUCT.</div>		<div>CAUTION:</div> <div>INTER-LUX IS NOT RESPONSIBLE FOR THE STRUCTURAL INTEGRITY OF THE BUILDING TO SUPPORT THE LUMINAIRE. ADDITIONAL BACKING MAY BE REQUIRED.</div>

WIRING DIAGRAM

