

edgeless cove



A 'plaster-in' linear cove system to create architectural lighting details, either horizontally or vertically mounted.

Applications:

- Where the ceiling is to be plastered or re-plastered with a gypsum finish.

Features:

- Overlapping fixed single or twin lamp options.
- Angled front face to block direct view of the lamps and give minimal visual impact.
- Produced to site dimensions.
- Pre-wired complete unit including control gear and overlapping lamp positions.
- All sections are site delivered in sections with pre-wired plug connectors and single position mains supply point.

Control options:

- Switched
- Analogue (1-10v)
- Digital (DSI)
- DALI
- Single circuit
- Multi circuit

code	lamp	type	base	watts	lumen
TP-LC1-1x1-(Length)	Single fluorescent overlapped	T5	G5	24W per meter	2200 lm per meter
TP-LC1-2x1-(Length)	Twin fluorescent overlapped	T5	G5	48W per meter	4400 lm per meter
TP-LC-3x3-(Length)	Triple fluorescent overlapped	T5	G5	72W per meter	6600 lm per meter
TP-LC2-4x2-(Length)	Two sets of twin fluorescents overlapped	T5	G5	96W per meter	8800 lm per meter
TP-LC2-4x4-(Length)	Quadruple T5 fluorescent overlapped	T5	G5	192W per meter	17600 lm per meter
TP-LC-LED iC-1X1-(length)	LED system	--	--	36W or 9W per meter	--
TP-LC-LED eW-1X1-(length)	LED system	--	--	36W or 9W per meter	--

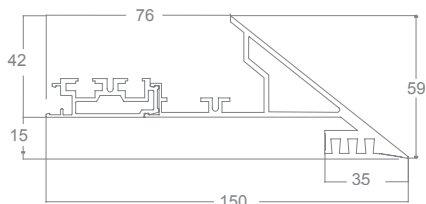

- 1 structural ceiling
- 2 lower ceiling support
- 3 vertical reflective surface
- 4 edgeless cove twin overlapping system (TP-LC1-2x1)
5. Additional bracket

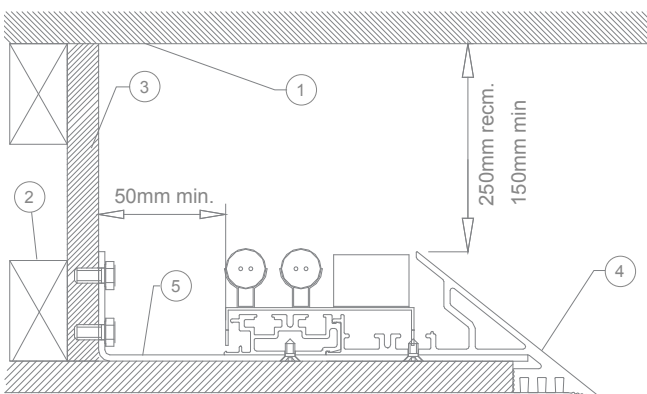

Examples:

TP-LC1-3X3-6000 (where 6000mm is the linear length) plaster in edgeless cove profile with three runs of separately circuited lamps (usually RGB).

TP-LC1-2X1-6000 (where 6000mm is the linear length) plaster in edgeless cove profile with twin overlapping lamps on a single circuit (our most popular cove format).

TP-LC1-4X2-6000 (where 6000mm is the linear length) plaster in edgeless cove profile with two sets of twin overlapping lamps (4 lamps). Each pair on a circuit (usually for warm to cool control).

Notes:

- Where mitred corners or applications other than straight runs are required an indicative dimensional drawing is preferred.
- Lamp configuration is dependent on luminaire length and layout.
- Please specify control gear required when ordering.
- LED options available, please contact us for details.
- Dust cover available.
- Edgeless Cove nose only available.
- A installation without an "L" bracket requires a 15mm plasterboard. An installation with "L" bracket requires a 12,5mm plasterboard.

Other information:

Installation instructions	Page 170
Lamp configuration	Page 172-175
Important information	Page 181
Accessories	Page 185